

Residential land 4375 m²

Limassol, Souni-4717 , Cyprus

Offered at: € 330,000

Estate ID: 19373

Ref: ba2688957

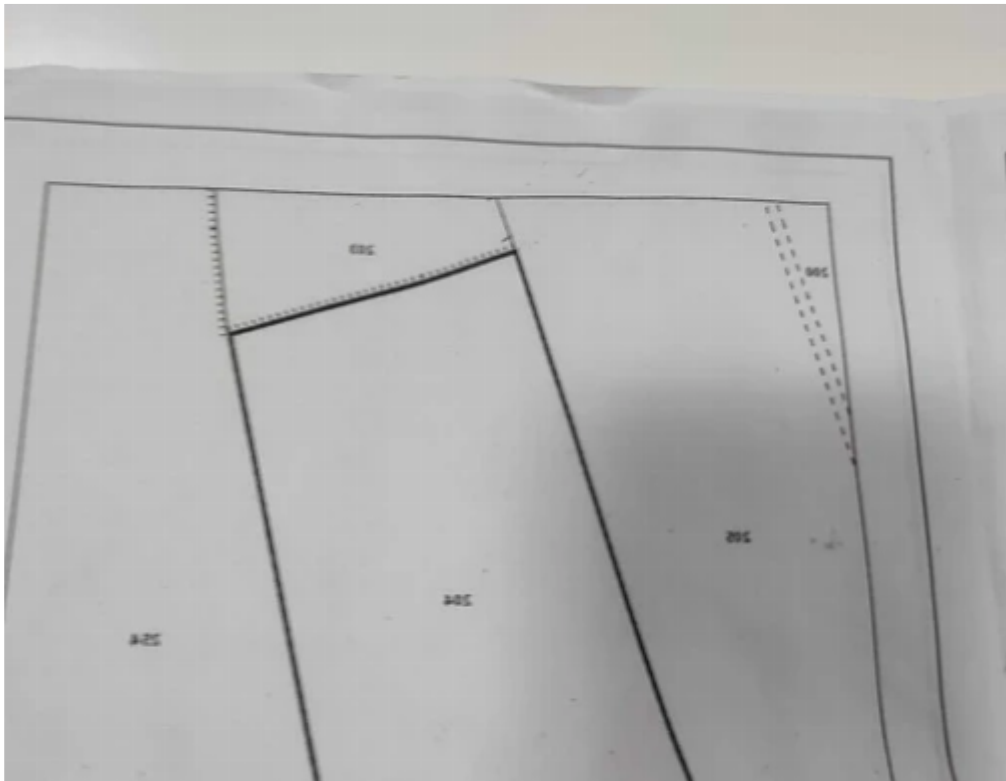
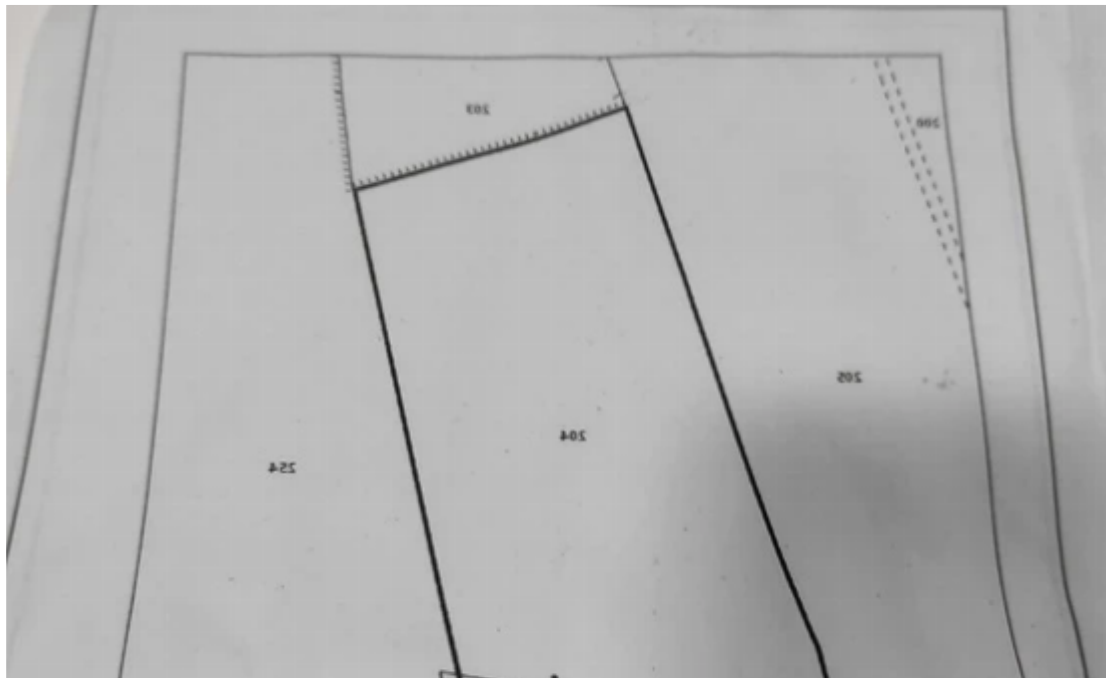



Total plot's-land's area: **4375 m²**



Available from: **2025-10-30**



Offered at: **330,000**



Type: **Residential**

For Sale: Residential Plot in Souni, Limassol – 4,375 m²? Location: Souni, Limassol ? Postal Code: 4717 ? Building Density: 25%? Property Overview:Plot Size: 4,375 m²Zoning: ResidentialUtilities: Electricity & Water availableAccess: 5 minutes from the Paphos-Limassol highway? Key Features:Ideal for Residential Development: Perfect location for building homes or a private residence.Excellent Connectivity: Easy access to main roads and close to essential amenities.Great Investment Opportunity: Residential plots in this area are highly sought after.Building Density: 25% - allowing ample space for construction.? Additional Information:The plot is also open to exchange a...

Estate on map:



