

Residential land 2800 m²

Limassol, Moni-4525 , Cyprus

Offered at: € 115,000

Estate ID: 20473

Ref: ba5235820

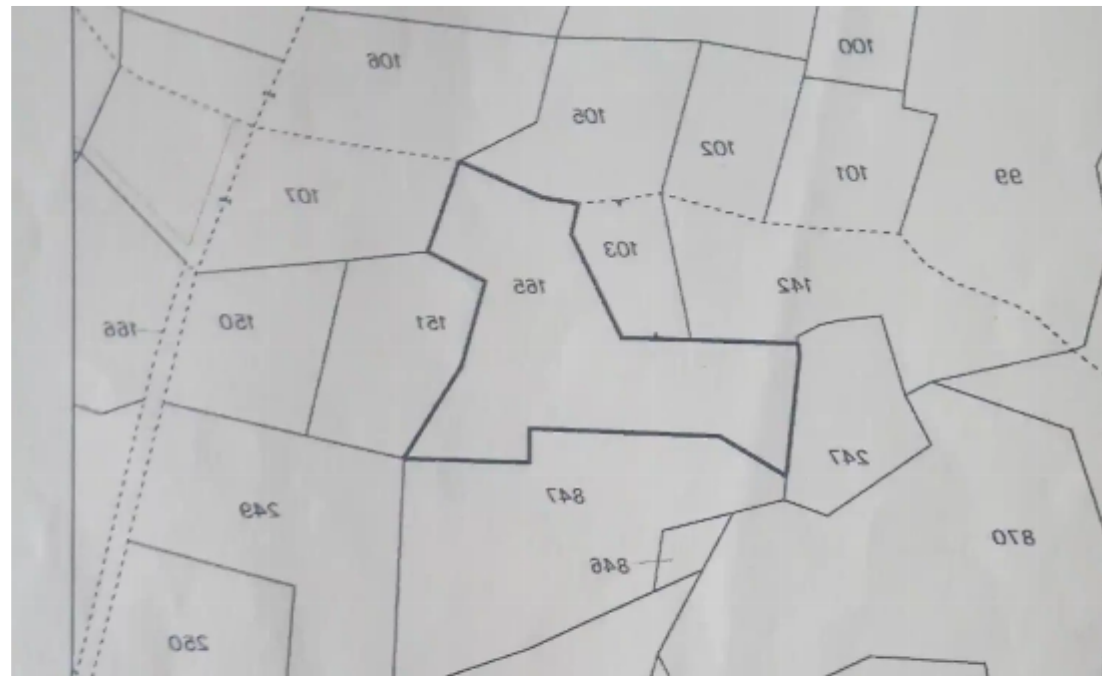

ΕΠΙΧΕΙΡΗ ΙΔΙΟΚΤΗΤΗΣ ΚΑΙ ΣΥΜΦΕΡΩΝ	
Όνομα και Διαθυσία	Μερίδιο
ANABE NIKOLAOS SS , ΠΑΤΡΟΣ, ΑΓΓΕΛΟΣ NIKOLAOS NIKOLAS	1\4

Εγγράφοι : 03\02\2006

ΚΙΝΗΤΗ ΙΔΙΟΚΤΗΤΙΑ

ΔΟΥΛΕΙΑ



Total plot's-land's area: **2350 m²**



Available from: **2025-10-30**



Offered at: **115,000**



Type: **Residential**

For Sale: Residential Plot in Moni Village, Limassol? Limassol, Moni? Plot Details:Plot Size: 2,350 m²Utilities: Electricity and water availableTitle Deed: Not issued yet? Highlights:Located just 1 km from Moni village and 2 km from the highway, offering quick and easy access to Limassol city.Spacious area ideal for residential development or investment purposes.Peaceful suburban location growing in popularity among families and buyers looking for a balance between nature and urban proximity....

Estate on map:



