



2-bedroom apartment f?r s?le

€389.000

Limassol, Logos-School-Nikou-Pattichi-St-Agios-Georgios-3071 ,
Cyprus

Offered at: € 389,000

Estate ID: 21454

Ref: ba4905011

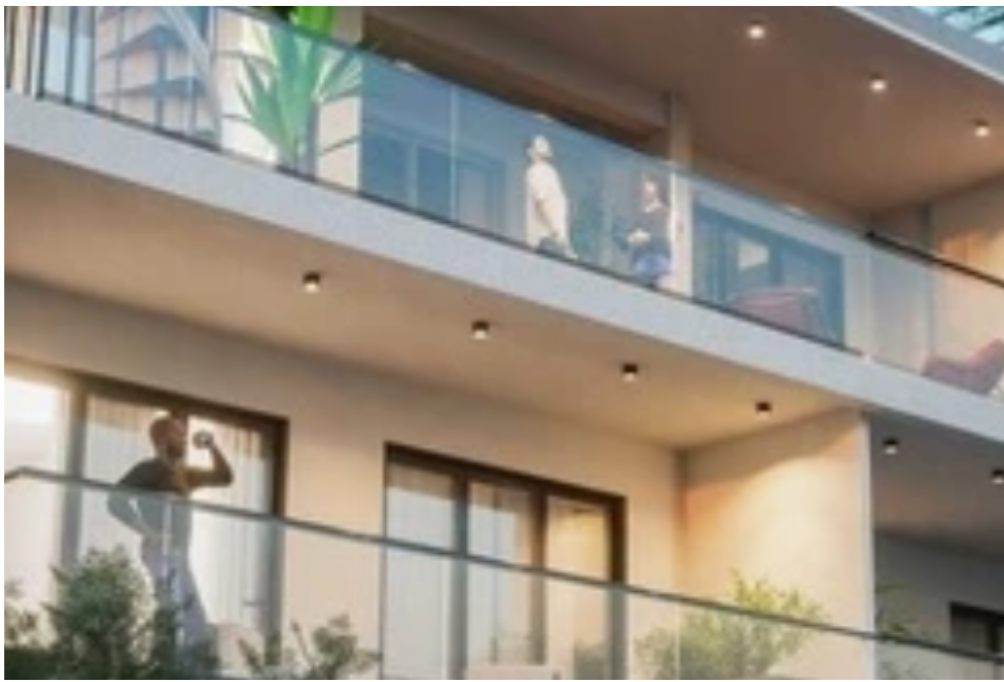



NET internal area: **95**



Bathrooms: **2**



Bedrooms: **2**



Parking spaces: **Covered cars**



Available from: **2024-03-30**



Offered at: **389,000**



Type: **Apartment**

....."The positioning of the Serene Residences enables Green Areas views to the surroundings of the Famous Famagusta Tennis Club & Courts on one end, and on the other, spectacular city views of Limassol. The project is City Centered and strategically positioned in a quiet area, offering easy access to the town center, nearby in proximity to public and private schools, banks, shops, and main amenities that make life easier in the city. Within a brief car drive, further of Limassol's attractions such as the MyMall Shopping Mall, The City of Dream Hotel and Casino Resort and much more this amazing city has to offer. This one-block, three-level, boutique eight unit project set...

Estate on map:



