



## **(Share) Residential land 1000 m<sup>2</sup>**

Limassol, Apesia-4541 , Cyprus

**Offered at:** € 95,000

**Estate ID:** 23323

**Ref:** ba5279733

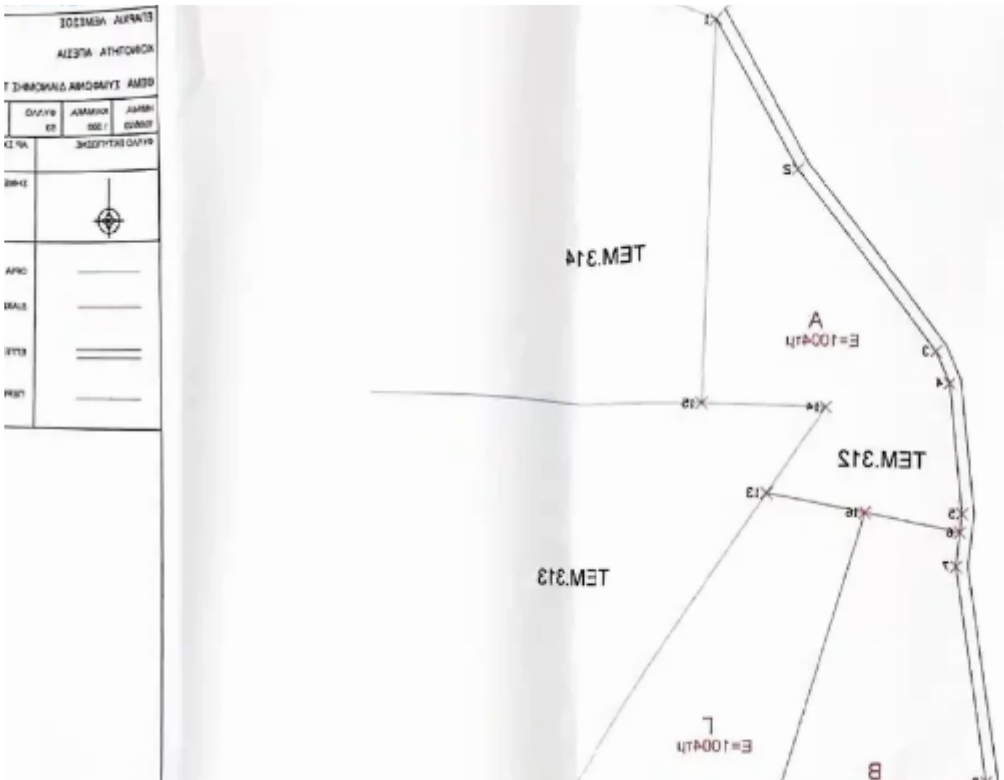

[illegible]



Total plot's-land's area: **1000 m²**



Coverage: **20 %**



Density: **20 %**



Available from: **2025-12-04**



Offered at: **95,000**



Type: **Residential**

For Sale: Residential Plot with Title Deeds in Apesia Village ? Limassol District, Apesia | Postal Code: 4541Plot Size: 1,000 m²Building Density: 20%Coverage Ratio: 20%Planning Zone: ResidentialTitle Deeds: ? AvailableViews: 312+? Property Overview: Located in the charming village of Apesia, this 1,000 m² residential plot offers an excellent opportunity to build a private countryside home just 10 minutes from Limassol city. Apesia is known for its peaceful surroundings, clean air, and beautiful natural landscapes—ideal for those looking to escape the busy city while staying close to all amenities.The plot falls within a residential planning zone, allowing for a construction of up...

## Estate on map:



