

U

[illegible]

Limassol, Trimiklini-4730 , Cyprus

**Offered at: € 90,000**

Estate ID: 23414

**Ref:** ba5035735

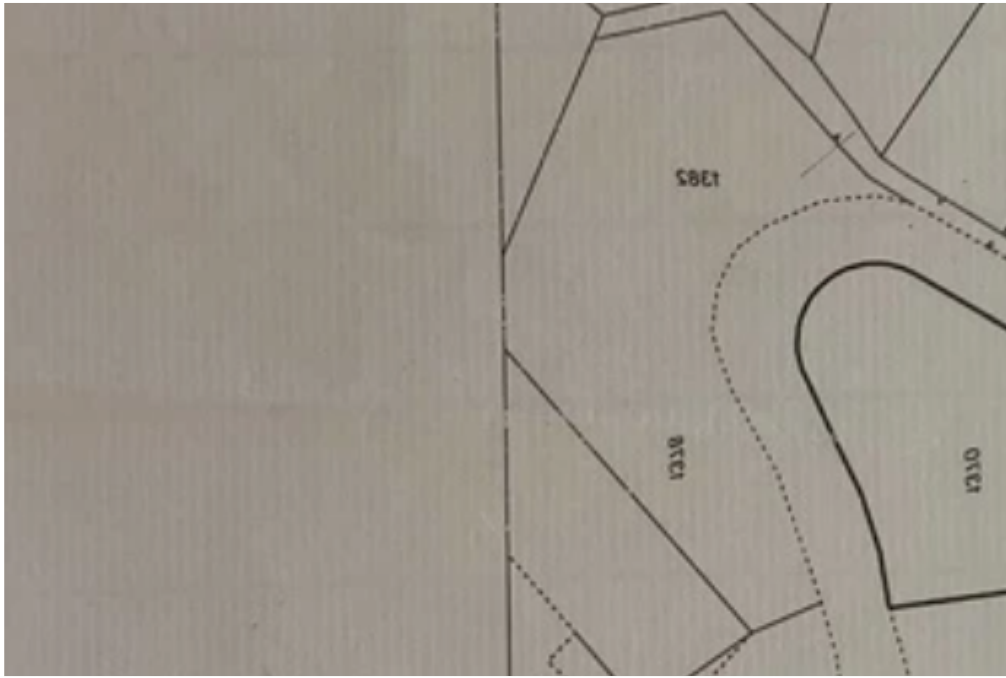



Total plot's-land's area: **989 m²**



Coverage: **15 %**



Density: **25 %**



Available from: **2025-12-04**



Offered at: **90,000**



Type: **Residential**

For Sale: Residential Plot in Trimiklini, Limassol? Location: Trimiklini, Limassol, Cyprus ? Parcel Size: 989 m²Key Features & Benefits:? Prime Location – Situated in the charming village of Trimiklini, this plot offers a peaceful environment while still being easily accessible to Limassol and the Troodos mountains. Perfect for those seeking a tranquil lifestyle.? Building Potential – With a building density of 25% and a coverage of 15%, this plot allows for the construction of a spacious residential property, making it an ideal choice for a family home or small development.? Natural Setting – Trimiklini is known for its picturesque surroundings, offering fresh air and...

## Estate on map:



