



## **Agricultural land 6000 m<sup>2</sup>**

**€150.000**

Larnaka, Vavla-7713 , Cyprus

**Offered at:** € 150,000

**Estate ID:** 25059

**Ref:** ba5186161

3453/51H  
ΑΧ  
Η  
ε  
: μέλη . γράβ :  
ΟΛΟΓΟΓΡΑΦΟ ΤΩΝ ΜΕΛΩΝ

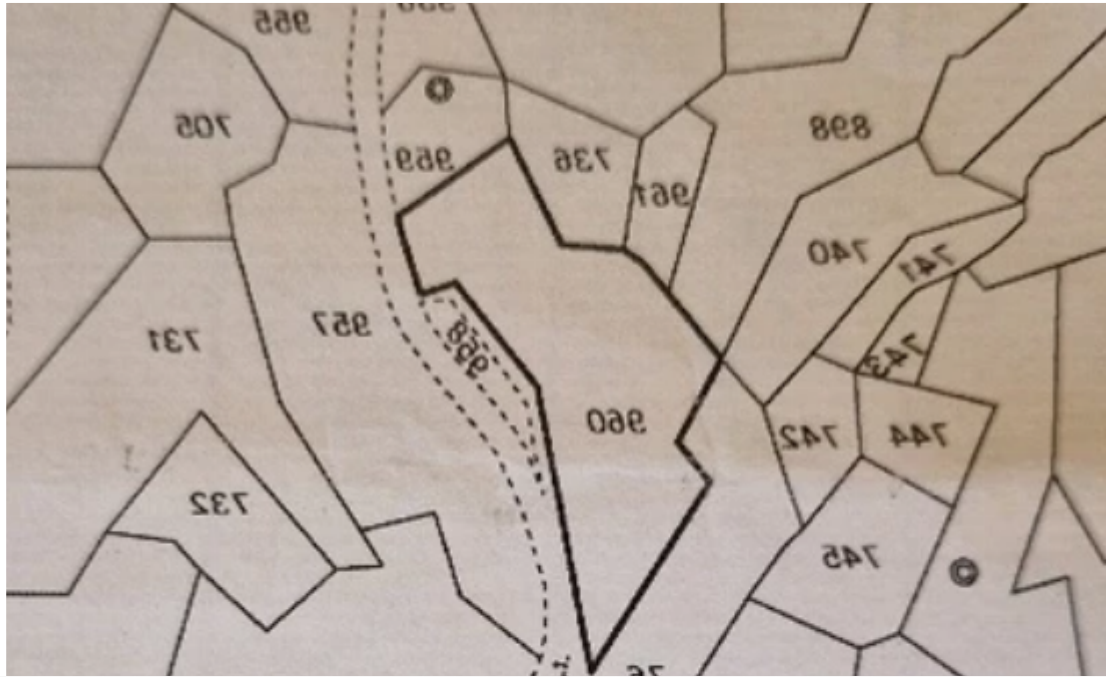



Total plot's-land's area: **6000 m<sup>2</sup>**



Available from: **2024-04-02**



Offered at: **150,000**



Type: **Agricultural**



Planning zone: **10%**

Agricultural and residential field for sale in Melini. This piece of land of 6000m<sup>2</sup>, is located in Melini village, just 20 minutes driving distance from Limassol and 20 minutes driving distance from Larnaca. It has an irregular shape and an inclined surface. It abuts onto a public registered Rorad. This property falls within a protection zone, having a building density of 10%. Immediate sale. Full title deed....

## Estate on map:

image not found or type unknown



