



Stylish 2-Bedroom Apartment in Central Limassol

Limassol, Agia-Filaxeos-Ave-Petros-And-Pavlos-3086 , Cyprus

Offered at: € 335,000

Estate ID: 28696

Ref: MLS-14491

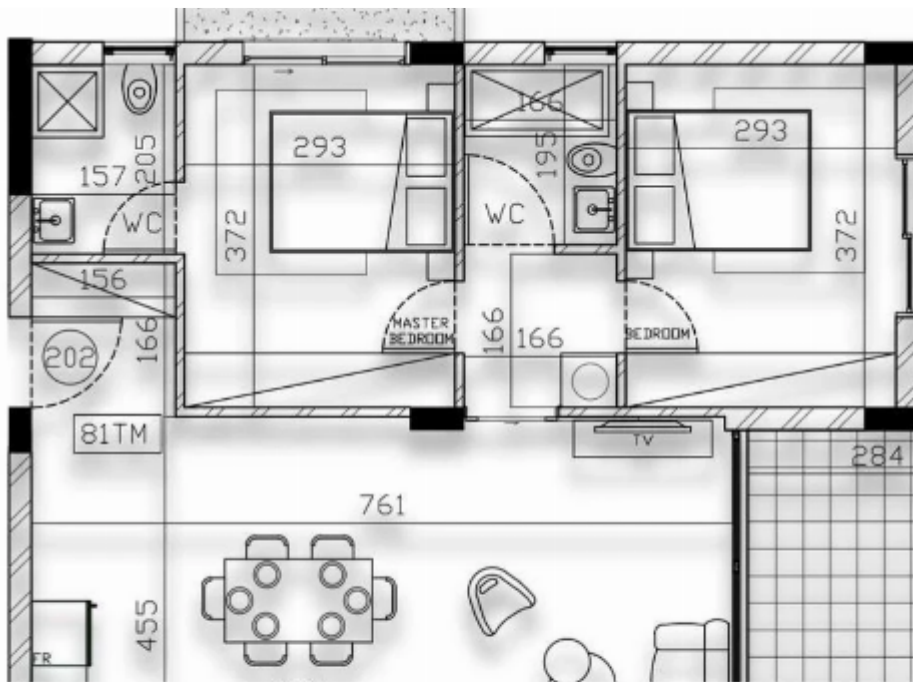



Bathrooms: **2**



Bedrooms: **2**



Available from: **2026-04-10**



Offered at: **335,000**



Type: **Apartment**



Veranda: **16 m²**

Welcome to your new home in the heart of Limassol, where contemporary elegance meets prime location. This brand-new 2-bedroom apartment offers a seamless blend of comfort, energy efficiency, and city convenience — perfect for those looking to buy apartment in Limassol or invest in new flats in Limassol for sale. Prime Location – Petrou & Pavlou Area: This apartment sits just off Agia Fylaxeos Avenue in the vibrant Petros and Pavlos neighborhood — one of Limassol's most desirable residential districts. The location offers unmatched connectivity and lifestyle benefits: Just 2 minutes from the Old Town and the beach Surrounded by shops, schools, cafés, and s...

Estate on map:

image not found or type unknown



