

2 bedrooms, 103 sq.m.

Limassol, Dassoudi-Park-Papas-Potamos-Germasogeias-4040 ,
Cyprus

Offered at: € 345,000

Estate ID: 29559

Ref: J3684L1340

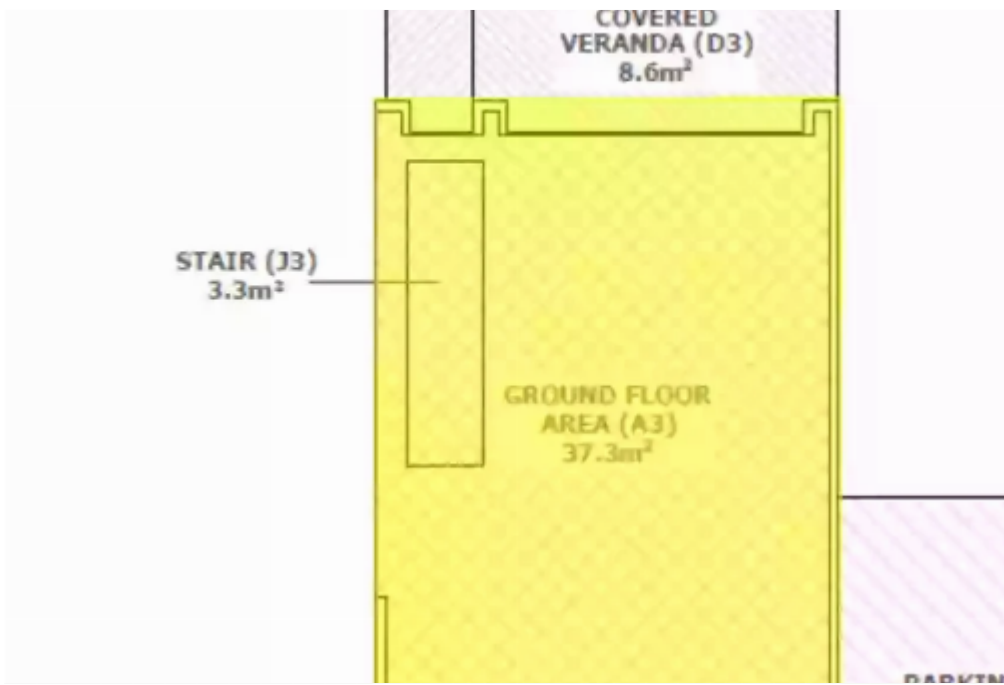



NET internal area: **103**



Bathrooms: **2**



Bedrooms: **2**



Parking spaces: **1 cars**



Available from: **2024-04-23**



Offered at: **345,000**



Type: **PrivateHouse**

Discover this private property, offering a comfortable net internal area of 103 square meters. Perfect for young professionals or a small family, it features two bedrooms and two bathrooms, all with a stunning mountain view. The interior is unfurnished, allowing you to express your style and creativity.

Owned by a company, this property is equipped with AC heating, ensuring a pleasant atmosphere throughout the year. You'll have one dedicated parking space for your convenience. Step outside to the verandas and garden, where you'll find a barbecue space, children's playground, and a private garden. Whether you love outdoor dining or playtime with the kids, this space is perfect for all ...

Estate on map:

image not found or type unknown



