

## 3 bedrooms, 100

Limassol, Parekklesia-4520 , Cyprus

**Offered at:** € 384,900

**Estate ID:** 29778

**Ref:** J3430L1179

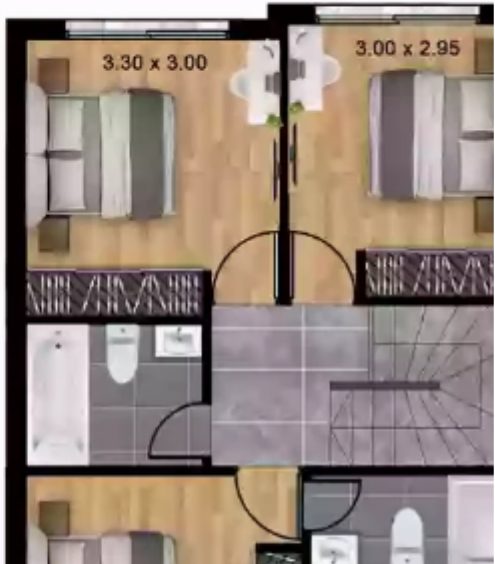



NET internal area: **100**



Bathrooms: **2**



Bedrooms: **3**



Parking spaces: **1 cars**



Available from: **2024-04-23**



Offered at: **384,900**



Type: **SemidetachedHouse**



Veranda: **13 m²**

Charming 3-Bedroom Semidetached House with Parking Discover this exceptional semidetached house, known as House 34, boasting three spacious bedrooms, nestled in a serene location. With an internal covered area of 100 square meters and an inviting covered veranda spanning 13 square meters, this home offers ample space for relaxation and entertainment. Situated on a generously sized plot measuring 106 square meters, this property provides you with the perfect opportunity to create your dream outdoor oasis. The convenient parking space ensures hassle-free parking for you and your family. Immerse yourself in the comforts of this delightful semidetached house, ideal for creating lasting me...

## Estate on map:

