



2-bedroom apartment f?r s?le

€359.900

Limassol, Super-Home-Center-Timou-Prodromou-Mesa-Geitonia-4004 , Cyprus

Offered at: € 359,900

Estate ID: 43498

Ref: ba5276902

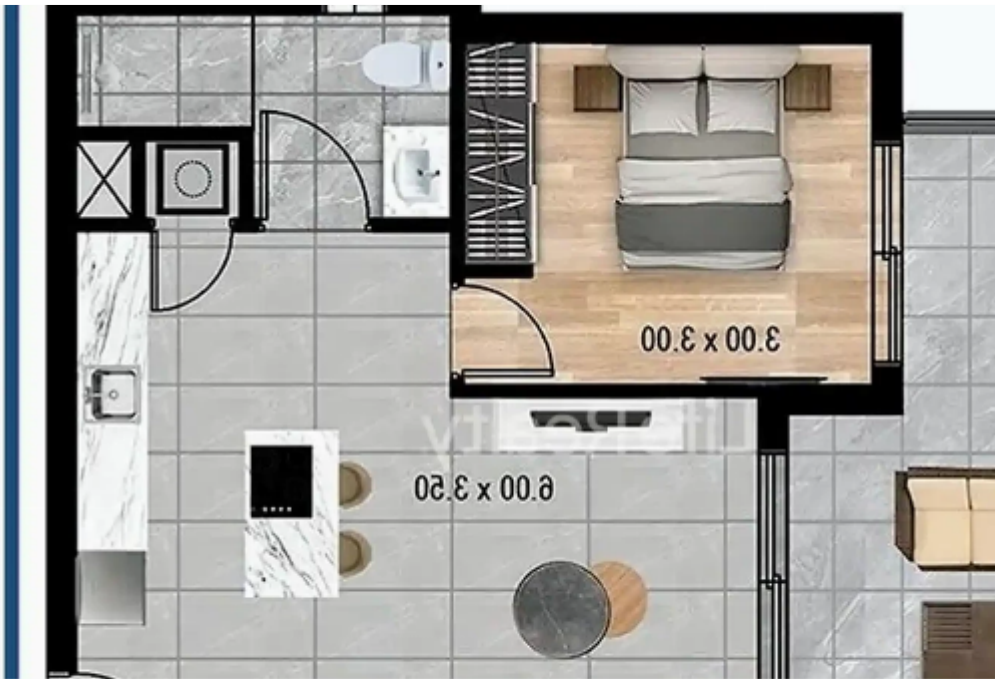



NET internal area: **80**



Bathrooms: **2**



Bedrooms: **2**



Parking spaces: **Covered cars**



Available from: **2024-06-02**



Offered at: **359,900**



Type: **Apartment**

Introducing this spectacular three-floor building, nestled in the most luxurious and desirable area of Germasogeia in Limassol. Conveniently close to many amenities, it's just a quick 10-minute drive from Limassol city center and offers easy access to the highway within a 5-minute drive. With its high-quality finishes, these apartments provide both renters and potential buyers with a unique opportunity to live in a luxurious and beautiful area. These apartments boast an ideal location, with the beach just a short 10-minute drive away. Additionally, they are conveniently situated near schools, banks, and markets. This prime location ensures a perfect blend of convenience and luxury, maki...

Estate on map:

