



3-bedroom semi-detached for sale

Limassol, Palodeia-4549 , Cyprus

Offered at: € 365,000

Estate ID: 66210

Ref: ba5474941

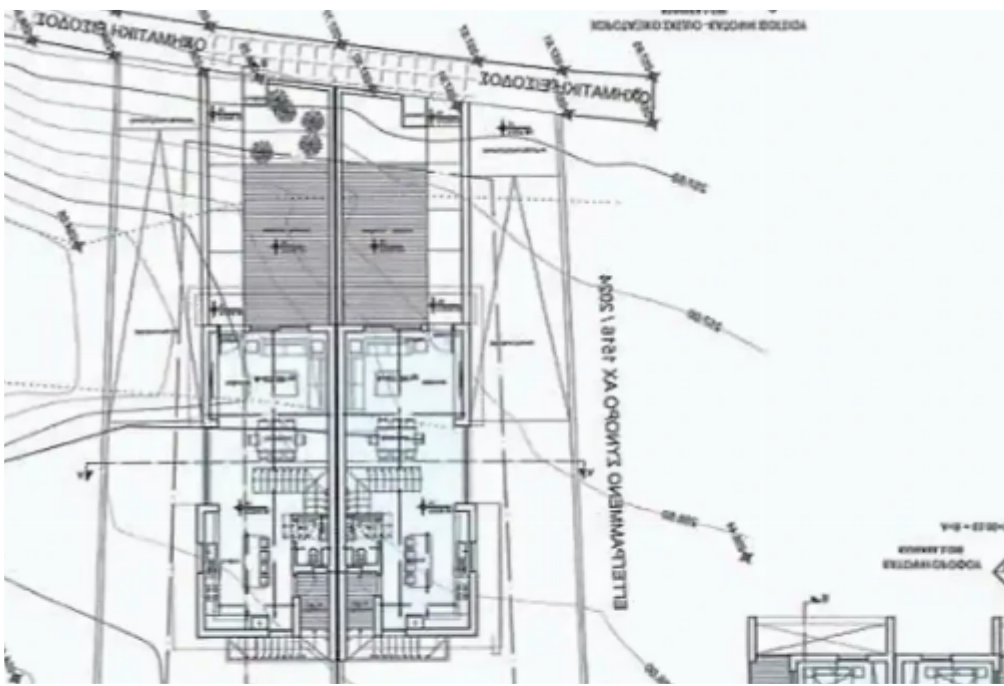



NET internal area: **134**



Bathrooms: **2**



Bedrooms: **3**



Parking spaces: **Covered cars**



Available from: **2024-10-11**



Offered at: **365,000**



Type: **SemidetachedHouse**

""""This project consists of two semi-detached houses situated on a spacious 620 m² plot. Each house features a well-designed layout across three levels, offering ample living space and modern amenities. **House Layout:** - **Basement Level:** This level includes parking facilities and a warehouse area, along with a shower, toilet, and laundry room for added convenience. - **Ground Floor Level:** The ground floor boasts an open-plan living room that is seamlessly connected to the kitchen. It also features a W/C, a large entrance veranda, and a kitchen veranda, ideal for outdoor dining and entertaining. - **First Floor:** The first floor is home to three comfortable bedrooms, which incl...

Estate on map:



