



## 2-bedroom apartment f?r s?le

Limassol, Pano-Polemidia-4130 , Cyprus

**Offered at:** € 310,000

**Estate ID:** 70055

**Ref:** ba5018249

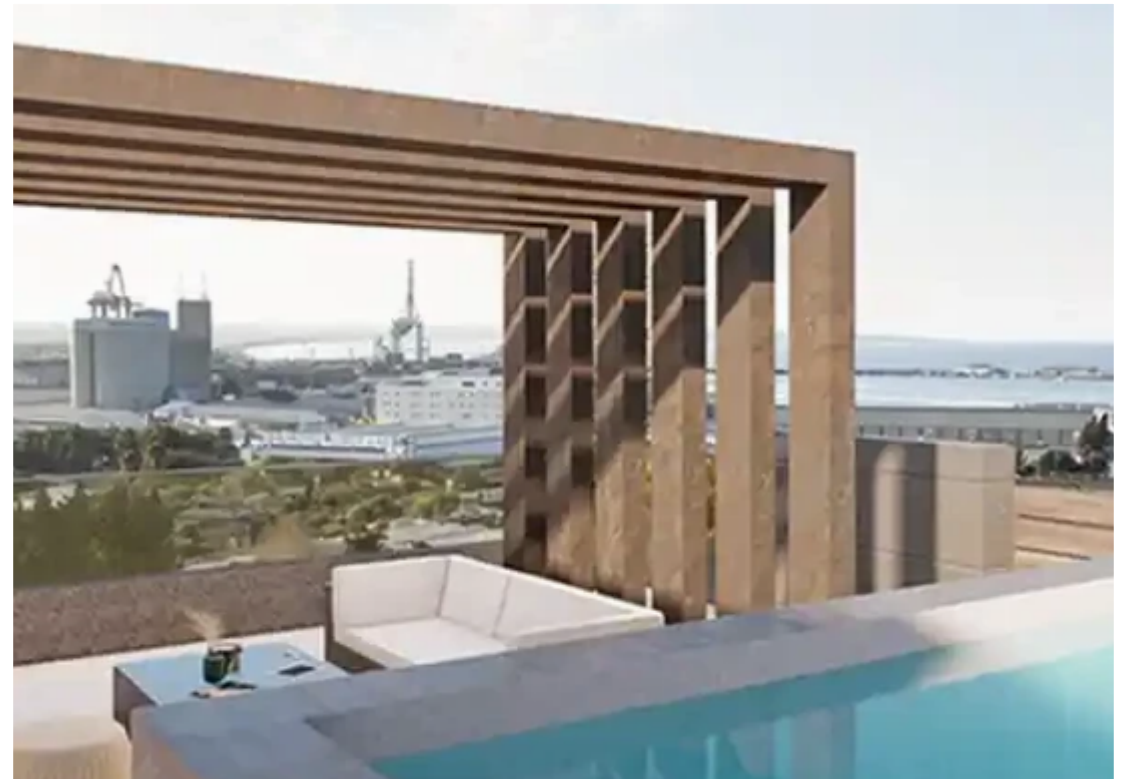



NET internal area: **99**



Bathrooms: **2**



Bedrooms: **2**



Parking spaces: **Covered cars**



Available from: **2024-10-25**



Offered at: **310,000**



Type: **Apartment**

.....In the serene and safe residential neighbourhood of Ekali, there stands a three-storey building offering six spacious two-bedroom apartments. Its a minutes drive from the motorway and within reach of all the amenities you need. The apartments are beautifully designed with a balance of modern comfort, functionality, and style. Each apartment spans an internal area of 78.8 square meters, supplemented by a 21.6 square meter covered veranda. Every unit also comes with its own storage room and a covered parking space. The design of these apartments leans towards modernity, with sleek interiors complemented by cosy elements for warmth. The large balconies featuring frameless glass ...

## Estate on map:

image not found or type unknown



