



Residential land 20565 m²

Limassol, Pano-Polemidia-4130 , Cyprus

Offered at: €7,500,000

Estate ID: 82335

Ref: ba5524226

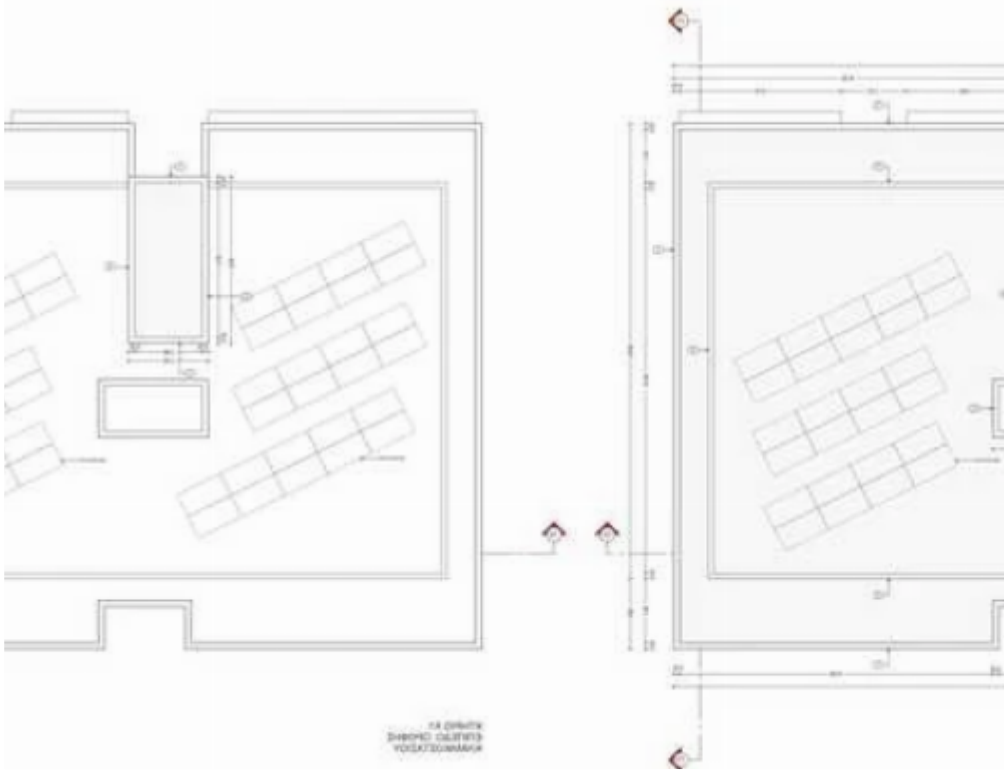



Total plot's-land's area: **20565 m²**



Available from: **2024-11-20**



Offered at: **7,500,000**



Type: **Residential**

.....15774 This exceptional residential project is strategically situated in the Pano Polemidia area of Limassol, directly opposite the New Hospital. It offers residents the unique advantage of unobstructed sea views from all apartments, ensuring a serene and picturesque living environment. The project combines modern design with convenient access to local amenities. With a focus on quality and comfort, each apartment is designed to maximize natural light and sea vistas, creating a warm and inviting atmosphere. The area is well-connected, providing easy access to both the vibrant city life and tranquil coastal experiences. Additionally, the project can be sold alongside another...

Estate on map:

image not found or type unknown





1A 01/17
 (EÖN-1) 2017/1 (2017/1) HYO A1/17

