



3-bedroom semi-detached for sale

Limassol, Palodeia-4549 , Cyprus

Offered at: € 365,000

Estate ID: 87528

Ref: ba5556932

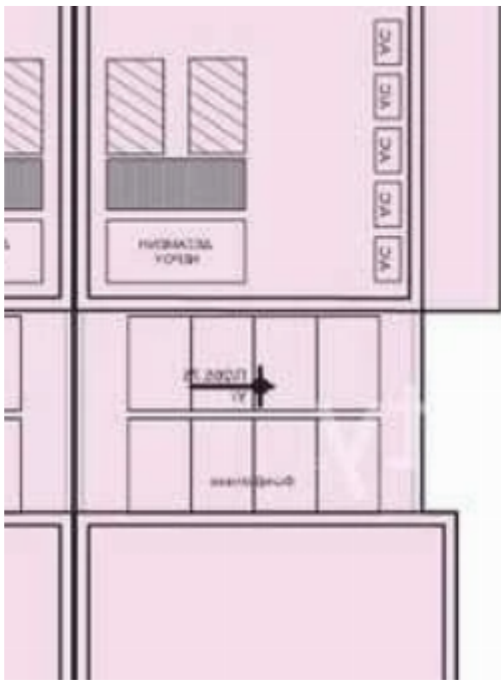



Bathrooms: **4**



Bedrooms: **3**



Parking spaces: **Covered cars**



Available from: **2024-12-04**



Offered at: **365,000**



Type: **SemidetachedHouse**

Introducing these exceptional 3-bedroom semi-detached houses, located in the serene village of Palodeia, Limassol. Just 20 minutes from the city center, these properties offer the perfect blend of luxury and family living. Each home features a spacious private garden, creating a peaceful and inviting outdoor space. The ground floor includes a bright and open living and dining area seamlessly connected to a modern kitchen, along with a guest WC, offering a functional and welcoming layout. Upstairs, you'll find three generously sized bedrooms, including a master bedroom with an en-suite bathroom and walk-in closet, plus an additional bathroom to ensure comfort and convenience for all r...

Estate on map:

image not found or type unknown



