

## Residential land 4375 m<sup>2</sup>

Limassol, Souni-4717 , Cyprus

This ad is presented by listings admin, under supervision from ,  
Licensed Real Estate Agent Reg no: 1234, Lic no: 603/E

**Offered at:** €330,000

**Estate ID:** 19373

**Ref:** ba2688957

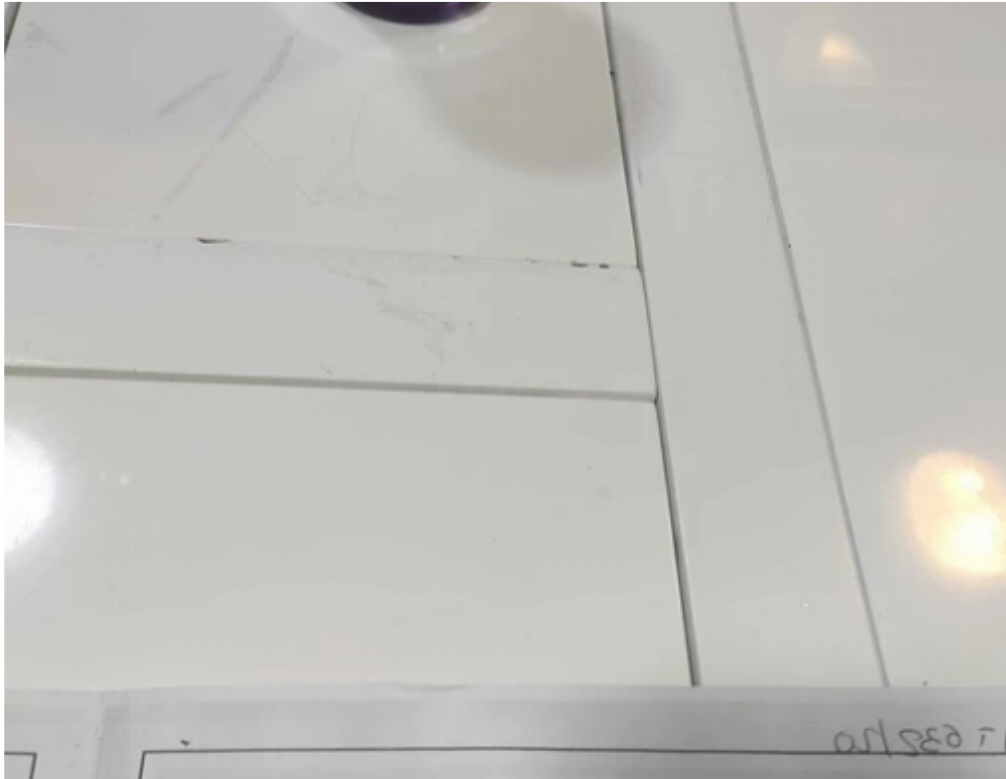
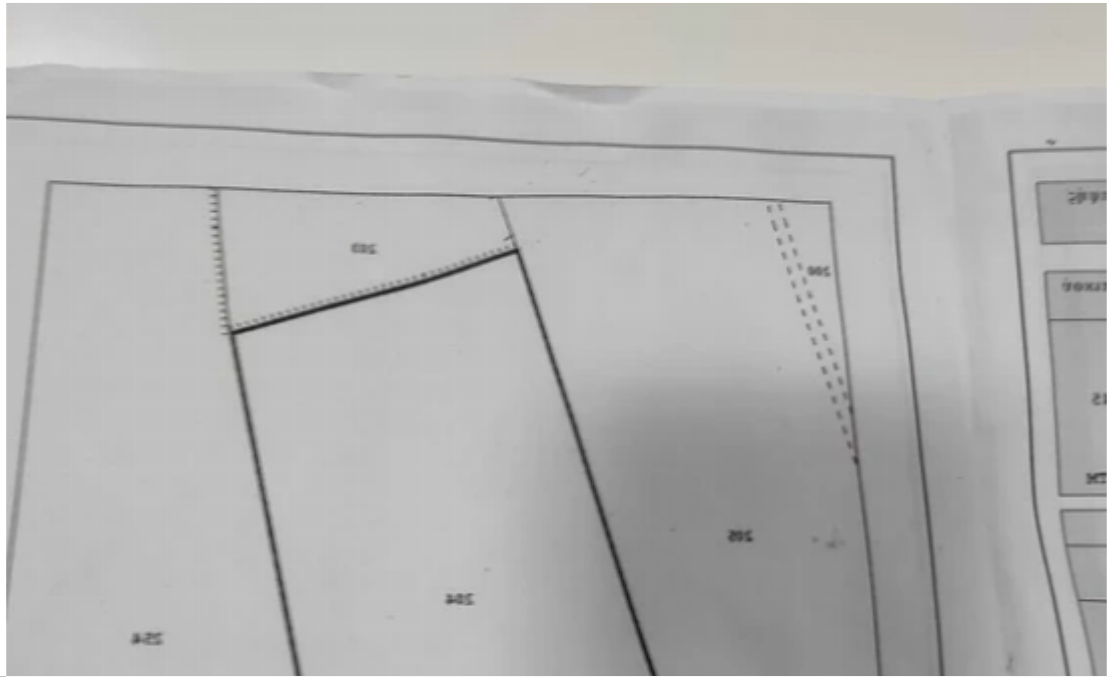
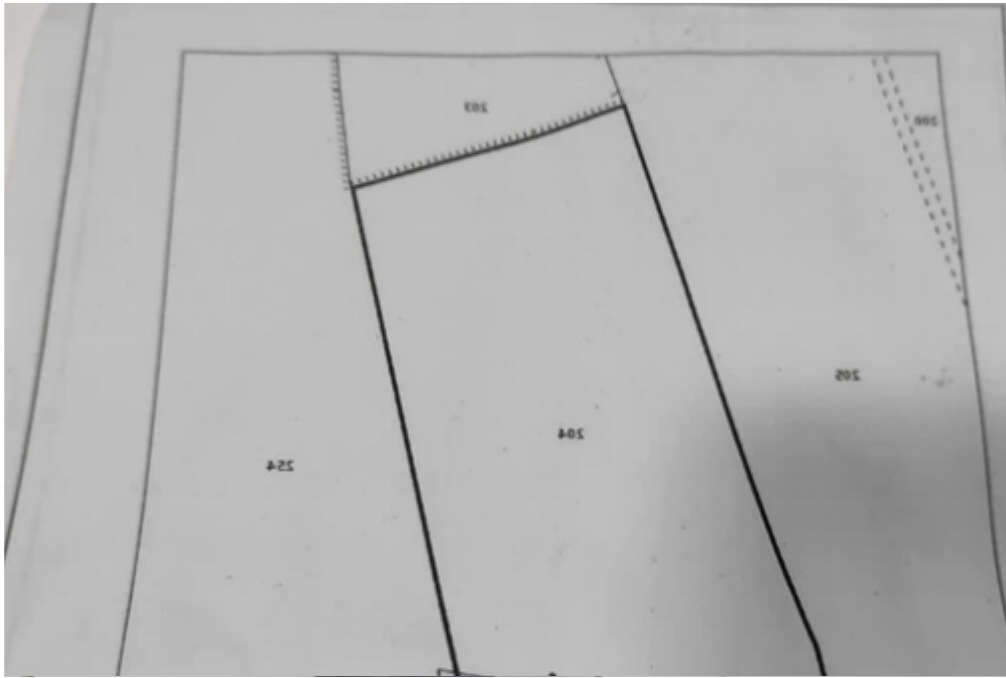



Total plot's-land's area: **4375 m²**



Available from: **2025-10-30**



Offered at: **330,000**



Type: **Residential**

For Sale: Residential Plot in Souni, Limassol – 4,375 m²? Location: Souni, Limassol ? Postal Code: 4717 ? Building Density: 25%? Property Overview:Plot Size: 4,375 m²Zoning: ResidentialUtilities: Electricity & Water availableAccess: 5 minutes from the Paphos-Limassol highway? Key Features:Ideal for Residential Development: Perfect location for building homes or a private residence.Excellent Connectivity: Easy access to main roads and close to essential amenities.Great Investment Opportunity: Residential plots in this area are highly sought after.Building Density: 25% - allowing ample space for construction.? Additional Information:The plot is also open to exchange a...

## Estate on map:





**Website:** [realty.com.cy/p/residential-land-4375-m²-ba2688957](https://realty.com.cy/p/residential-land-4375-m²-ba2688957)

**Email:** [om@liferealty.cy](mailto:om@liferealty.cy)

**Phone:** [+35795958898](tel:+35795958898) // [+35725714014](tel:+35725714014)

This ad is presented by listings admin, under supervision from ,  
Licensed Real Estate Agent Reg no: 1234, Lic no: 603/E