



Residential land 780 m²

Limassol, Synergatismou-St-Kato-Polemidia-4159 , Cyprus

This ad is presented by listings admin, under supervision from ,
Licensed Real Estate Agent Reg no: 1234, Lic no: 603/E

Offered at: €550,000

Estate ID: 19402

Ref: ba5270678

<p> ΔΙΚΑΙΩΜΑΤΑ \ ΔΟΥΛΕΙΕΣ ΕΝΔΕΙΞΕΙΣ Αξία Τεχν. Εκτίμησης 01\01\2018 : €126.000,00 Αξία Τεχν. Εκτίμησης 01\01\2021 : €81.100,00 ΧΡΟΝΟΣ </p>			
<p> ΠΕΡΙΓΡΑΦΗ ΚΙΝΗΣΗΣ ΙΔΙΟΚΤΗΣΙΑΣ Επερχόμενη Εγγράφου : 12\04\2023 Αριθμός Φακέλου : 2\ΠΑΑ\13\2007 </p>			
<p> ΣΤΟΙΧΕΙΑ ΙΔΙΟΚΤΗΤΗ ΚΑΙ ΣΥΜΦΕΡΟΝ Αριθμός Μέγεθος </p>			
<p> 1025252 ΑΛΙΟΣ ΝΙΚΟΛΑΟΣ ΔΗΜΟΣ Κ. ΠΟΛΕΜΙΔΙΩΝ ΛΕΜΕΣΟΣ </p>			
<p> ΚΛΙΜΑΚΑ ΑΡΙΘΜΟΣ ΤΕΜΑΧΙΟΥ Αξία Τεχνικής Εκτίμησης 1.1.2018 Αξία Τεχνικής Εκτίμησης 1.1.2021 ΠΕΡΙΜΕΤΡΟΣ ΤΕΜΑΧΙΟΥ ΕΜΒΑΔΟ ΤΕΜΑΧΙΟΥ (μ.τ.ζ) </p>			
100%	100%	0.9	0.2
10	3	0.2	0.2

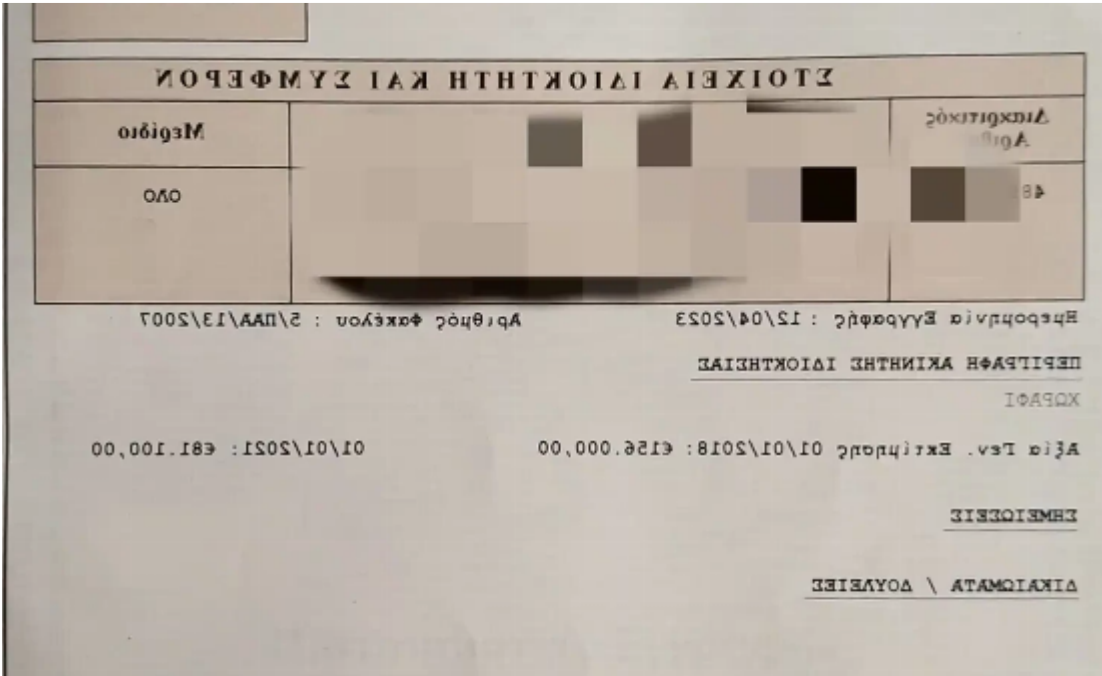
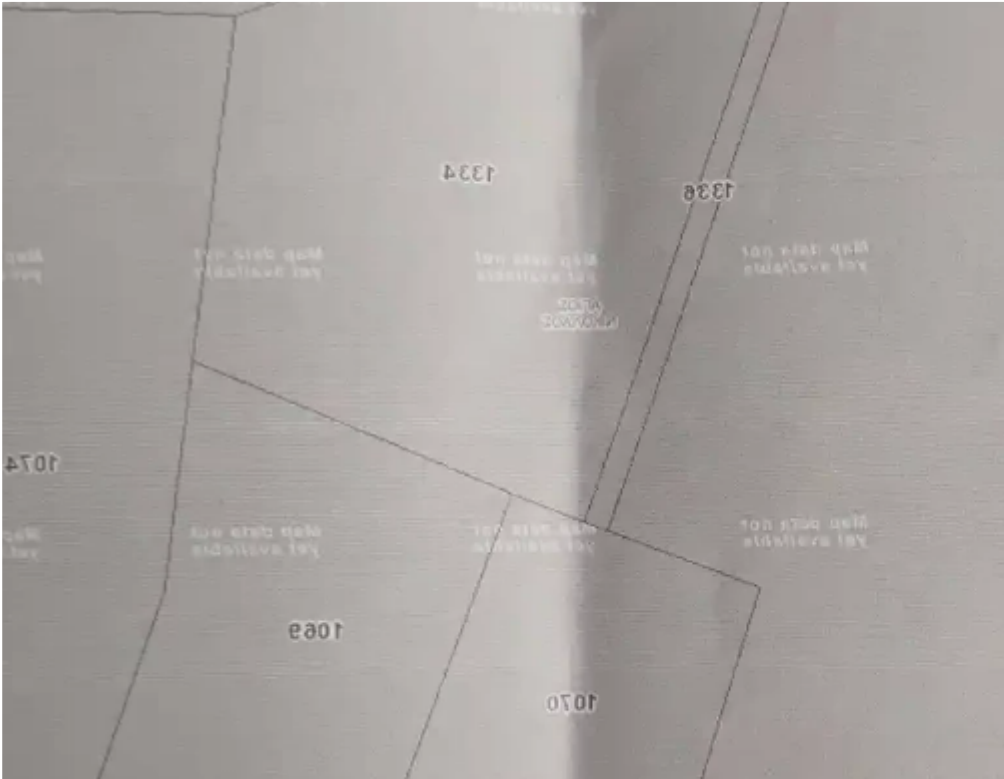



Total plot's-land's area: **780 m²**



Coverage: **0 %**



Available from: **2025-10-30**



Offered at: **550,000**



Type: **Residential**

For Sale: Residential Plot in Kato Polemidia, Limassol? Limassol District, Kato Polemidia Area Postal Code: 4159? Property Overview:A prime residential plot of 780 m² located in the Kato Polemidia area, Limassol, is available for sale. This plot is situated close to the General Hospital of Limassol, offering convenient access to essential services and amenities. With a planning zone Ka6, it is an ideal choice for residential development.?

Key Features:Plot Size: 780 m²Planning Zone: Ka6 (Residential)Road Frontage: Direct accessBuilding Coefficient: 90% (for reference, allows construction of multiple floors)Ideal for Development: Perfect for building up to 9 apartments, each with 2...

Estate on map:





Website: realty.com.cy/p/residential-land-780-m²-ba5270678

Email: om@liferealty.cy

Phone: [+35795958898](tel:+35795958898) // [+35725714014](tel:+35725714014)

This ad is presented by listings admin, under supervision from ,
Licensed Real Estate Agent Reg no: 1234, Lic no: 603/E