



Residential land 850 m²

Limassol, Mediterranean-Hospital-Agia-Phyla-Agia-Fylaxis-3117 ,
Cyprus

This ad is presented by listings admin, under supervision from ,
Licensed Real Estate Agent Reg no: 1234, Lic no: 603/E

Offered at: € 450,000

Estate ID: 20238

Ref: ba4967641

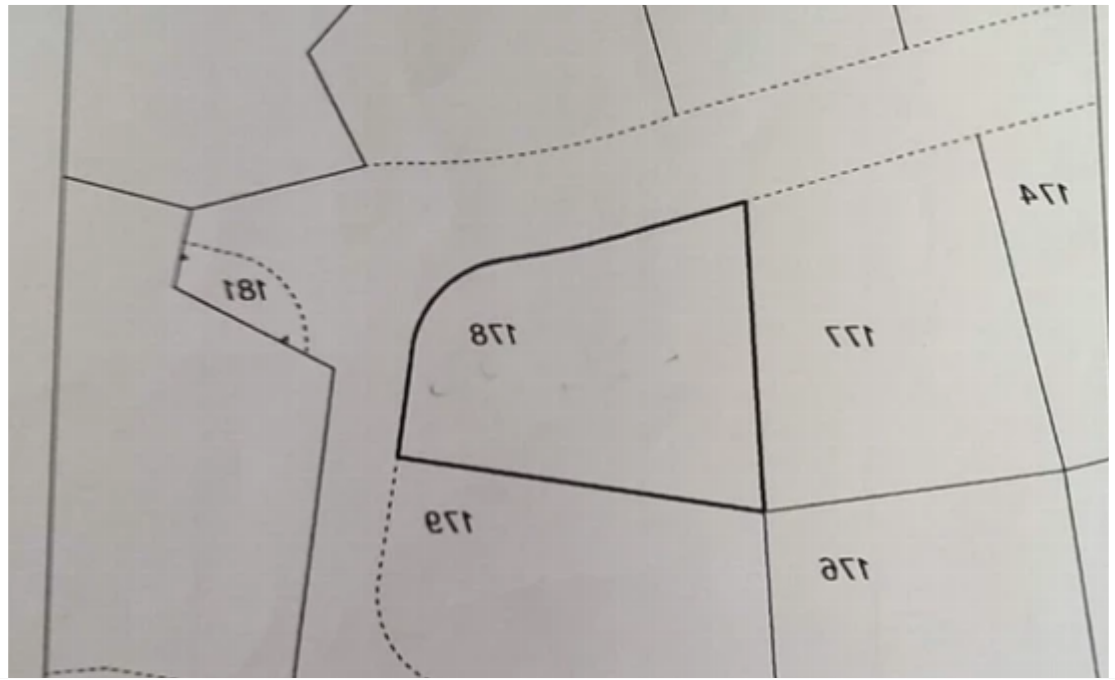



Total plot's-land's area: **850 m²**



Coverage: **30 %**



Density: **30 %**



Available from: **2024-03-30**



Offered at: **450,000**



Type: **Residential**

""Plot of land at prestigious Opalia Hill in Limassol (north of Panthea) with beautiful sea views.""...

Estate on map:

image not found or type unknown





Website: realty.com.cy/p/residential-land-850-m²-ba4967641

Email: info@rimatech.com.cy

Phone: [+35795958898](tel:+35795958898) // [+35725714014](tel:+35725714014)

This ad is presented by listings admin, under supervision from ,
Licensed Real Estate Agent Reg no: 1234, Lic no: 603/E

