



4-bedroom semi-detached for sale

Limassol, Pano-Polemidia-4130 , Cyprus

This ad is presented by listings admin, under supervision from ,
Licensed Real Estate Agent Reg no: 1234, Lic no: 603/E

Offered at: € 525,000

Estate ID: 20327

Ref: ba5606037

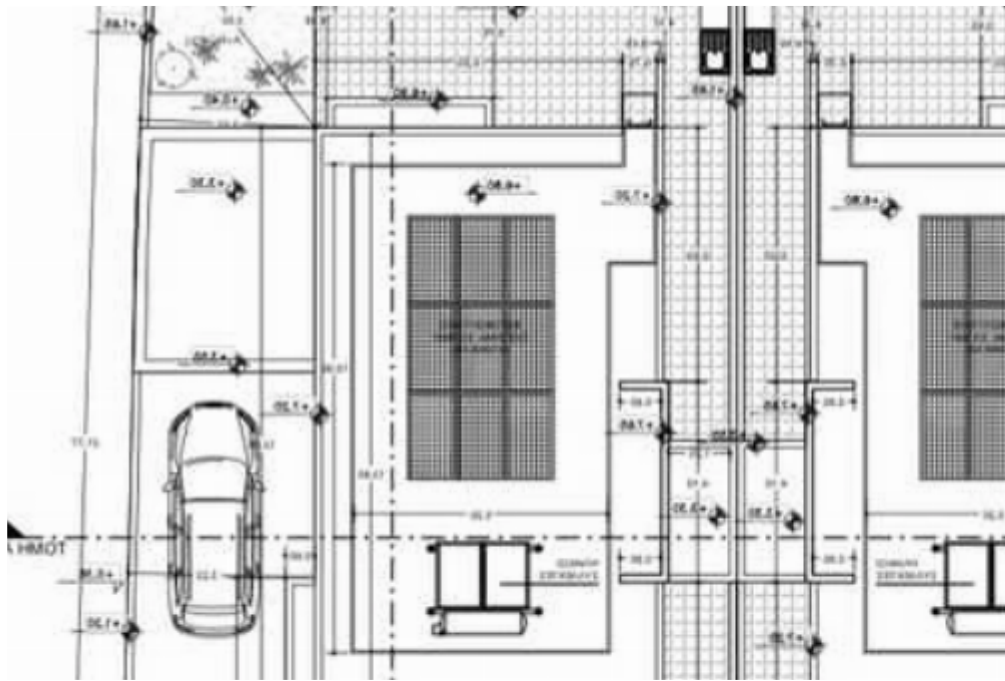



Bathrooms: **3**



Bedrooms: **4**



Parking spaces: **Covered cars**



Available from: **2025-10-30**



Offered at: **525,000**



Type: **SemidetachedHouse**

For Sale: Brand New 4-Bedroom Semi-Detached House in Pano Polemidia, Limassol ? Location: Limassol, Pano Polemidia ? Type: Semi-detached house ?? Bedrooms: 4 ? Bathrooms: 3 ? Parking: Covered ? Plot Size: 271 m² | Internal Covered Areas: ~199 m² ? Delivery: 2025 (under construction) ? Energy Efficiency: Category A? Property Highlights:Modern design: The project includes two semi-detached houses, perfect for families looking for comfort, privacy, and quality living.Spacious layout: 4 bedrooms and 3 bathrooms spread across two floors.Smart infrastructure: Provisions for A/C and all necessary appliances.Beautiful mountain views: Peaceful residential setting with na...

Estate on map:





Website: realty.com.cy/p/4-bedroom-semi-detached-f?r-s?le-ba5606037

Email: om@liferealty.cy

Phone: [+35795958898](tel:+35795958898) // [+35725714014](tel:+35725714014)

This ad is presented by listings admin, under supervision from ,
Licensed Real Estate Agent Reg no: 1234, Lic no: 603/E