

Residential land 2800 m²

Limassol, Moni-4525 , Cyprus

This ad is presented by listings admin, under supervision from ,
Licensed Real Estate Agent Reg no: 1234, Lic no: 603/E

Offered at: €115,000

Estate ID: 20473

Ref: ba5235820

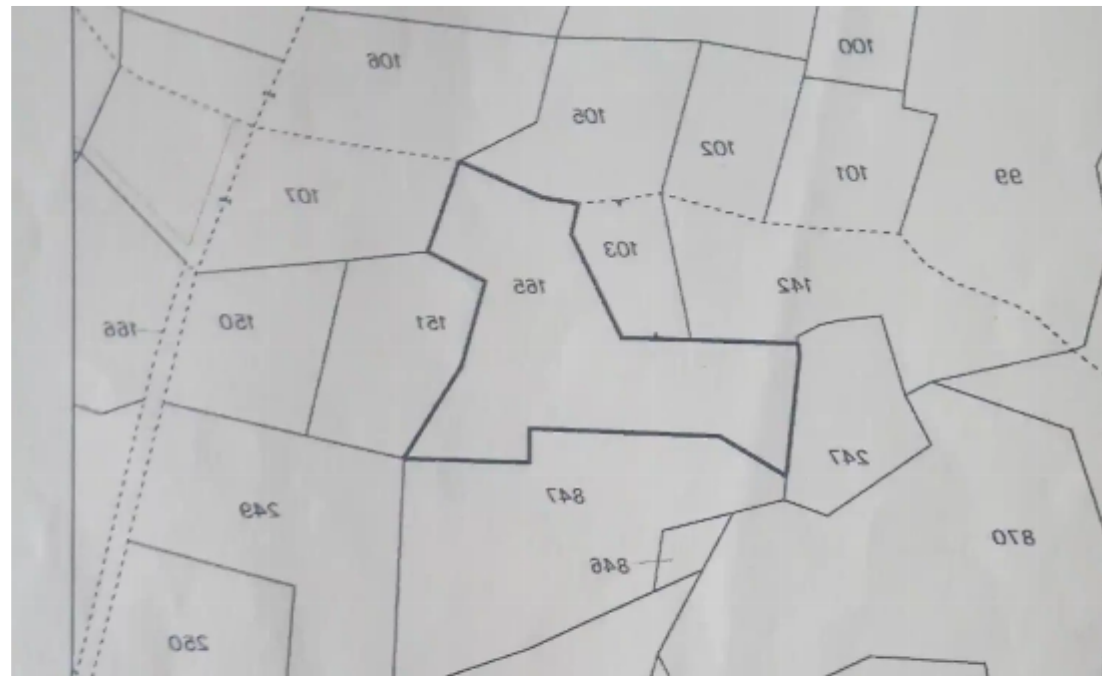

ΕΠΙΧΕΙΡΗΣΙΑΙΟΙ ΚΑΙ ΣΥΜΦΕΡΟΝ	
Όνομα και Διαμονή	Μερίδιο
ΝΙΚΟΛΑΟΣ ΝΙΚΟΛΑΟΣ ΑΝΔΡΕΑΣ ΝΙΚΟΛΑΟΣ ΣΣ, ΠΥΡΡΗ, ΑΕΜΕΣΟΣ	1/4

ΕΥΡΕΤΗΡΙΟ : 03/02/2006

ΕΠΙΧΕΙΡΗΣΙΑΙΟΙ ΚΑΙ ΣΥΜΦΕΡΟΝ

ΕΥΡΕΤΗΡΙΟ



Total plot's-land's area: **2350 m²**



Available from: **2025-10-30**



Offered at: **115,000**



Type: **Residential**

For Sale: Residential Plot in Moni Village, Limassol? Limassol, Moni? Plot Details:Plot Size: 2,350 m²Utilities: Electricity and water availableTitle Deed: Not issued yet? Highlights:Located just 1 km from Moni village and 2 km from the highway, offering quick and easy access to Limassol city.Spacious area ideal for residential development or investment purposes.Peaceful suburban location growing in popularity among families and buyers looking for a balance between nature and urban proximity....

Estate on map:





Website: realty.com.cy/p/residential-land-2800-m²-ba5235820

Email: om@liferealty.cy

Phone: [+35795958898](tel:+35795958898) // [+35725714014](tel:+35725714014)

This ad is presented by listings admin, under supervision from ,
Licensed Real Estate Agent Reg no: 1234, Lic no: 603/E