



## Residential land 1016 m<sup>2</sup>

**€245.000**

Limassol, Parekklesia-4520 , Cyprus

This ad is presented by listings admin, under supervision from ,  
Licensed Real Estate Agent Reg no: 1234, Lic no: 603/E

**Offered at:** € 245,000

**Estate ID:** 20530

**Ref:** ba4654151

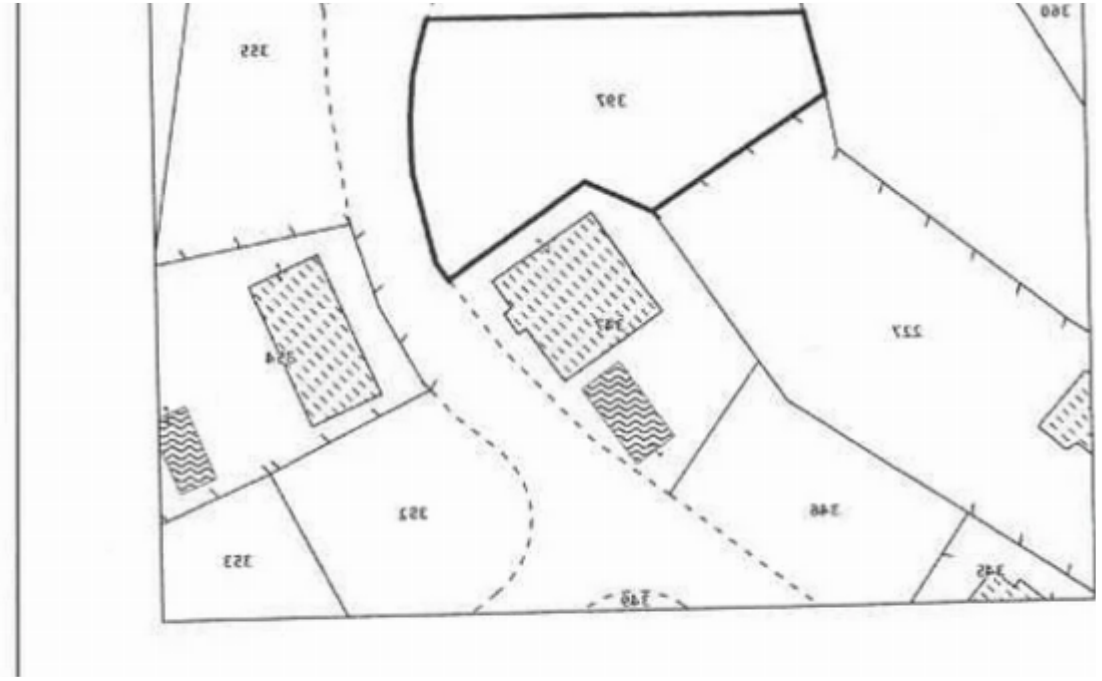



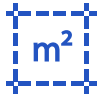

Total plot's-land's area: **1016 m<sup>2</sup>**



Density: **20 %**



Available from: **2024-03-30**



Offered at: **245,000**



Type: **Residential**

Plot in Parekklesia for sale 1016 sq meters 20% allowed build Sea view, quiet location Sold with project: 1 story 187sq meters, 3 bedroom, 2 car garage, sauna Project has all permissions, paid for, and ready to build. (Just to get permissions took 6+ months! You would be saving yourself a lot of time). Because building permit was obtained prior to the law change, the government tax on the building will be 5%, instead of new rate of 19% according to the implemented new law in 2023. Big saving if you use an existing permit to build! The plot has a clean title. No VAT Price: 245 000 Eur Government TAX: It is best to check with your Lawyer if you are required to pay Tax in this si...

## Estate on map:

image not found or type unknown





**Website:** [realty.com.cy/p/residential-land-1016-m<sup>2</sup>-€245.000-ba4654151](https://realty.com.cy/p/residential-land-1016-m2-€245.000-ba4654151)

**Email:** [info@rimatech.com.cy](mailto:info@rimatech.com.cy)

**Phone:** [+35795958898](tel:+35795958898) // [+35725714014](tel:+35725714014)

This ad is presented by listings admin, under supervision from ,  
Licensed Real Estate Agent Reg no: 1234, Lic no: 603/E

