



## New building near grammar school, offering promising returns. €7.000.000

Limassol, Panthea-Mesa-Geitonia-4007 , Cyprus

This ad is presented by listings admin, under supervision from ,  
Licensed Real Estate Agent Reg no: 1234, Lic no: 603/E

**Offered at:** €8,000,000

**Estate ID:** 27261

**Ref:** ba5212139





Welcome to Golden Heart, a premier real estate development nestled in the vibrant neighborhood of Mesa Grande. Each apartment offers residents a blend of modern living and convenience, situated within walking distance to amenities including schools, parks, and shopping. This development caters to the needs of families, young professionals, and individuals seeking an urban lifestyle with access to essential facilities.

Golden Heart boasts not only its strategic location but also its seamless connectivity to major transportation routes. Each apartment is thoughtfully designed to maximize space and functionality, featuring contemporary finishes and an abundance of natural light. Whether it's enjoying panoramic views from private balconies, cooking up culinary delights in the modern kitchen, or relaxing in the luxury spa, every detail is tailored to elevate your lifestyle in Mesa Grande.

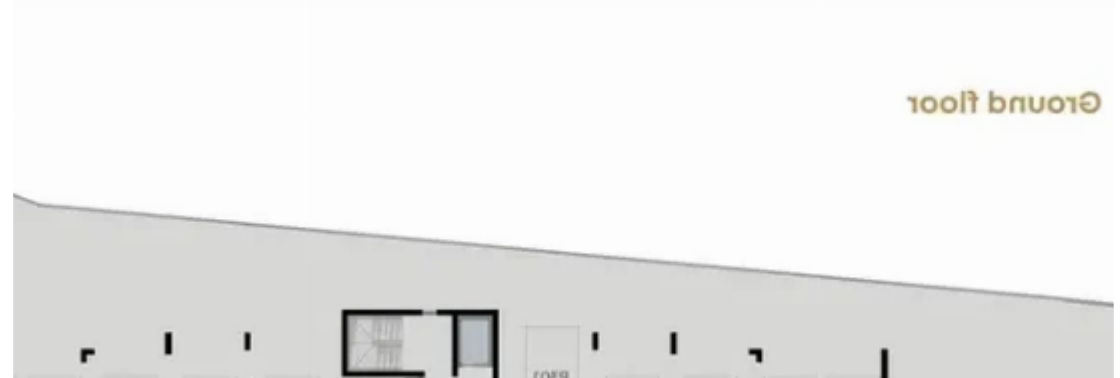

Ground floor



NET internal area: **1930**



Available from: **2024-04-17**



Offered at: **8,000,000**



Type: **Space**



Year of build: **2024**

Building near Grammar School: This luxurious three-story apartment building, currently under construction in the Mesa Geitonia (Panthea) area of Limassol, offers a total of 10 apartments ranging from 1, 2, to 3 bedrooms. It features an A energy efficiency certificate, thermal insulation frames, covered parking space, storage, security doors, intercom, etc. Comfortable and functional spaces, modernly designed with smart solutions to exploit all useful areas, large balcony, underfloor heating, air conditioning, etc. The penthouses feature a pool, garden, service room, and barbecue area, upgrading both the building and the apartments with an additional level of luxury and funct...

# Estate on map:

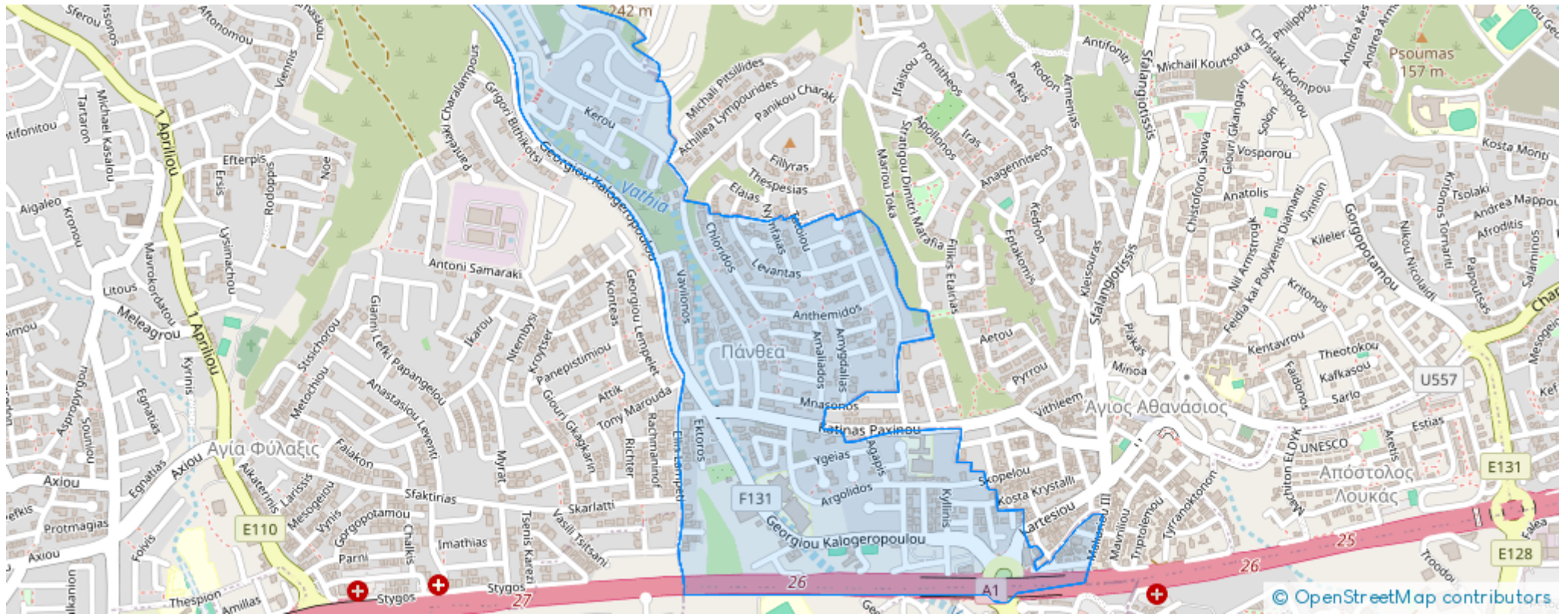

Storage	Bathrooms	Covered Verandas sqm.	Interior sqm.
1	2	32	120
1	1	8.2	42
1	1	8.2	42
1	2	32	120



**Website:** [realty.com.cy/p/new-building-near-grammar-school--  
offering-promising-returns.-€7.000.000-ba5212139](https://realty.com.cy/p/new-building-near-grammar-school-offering-promising-returns.-€7.000.000-ba5212139)

**Email:** [info@rimatech.com.cy](mailto:info@rimatech.com.cy)

**Phone:** [+35795958898](tel:+35795958898) // [+35725714014](tel:+35725714014)

This ad is presented by listings admin, under supervision from ,  
Licensed Real Estate Agent Reg no: 1234, Lic no: 603/E

