

Residential land 5016 m²

€350.000

Larnaka, Pyrgas-7648 , Cyprus

This ad is presented by listings admin, under supervision from ,
Licensed Real Estate Agent Reg no: 1234, Lic no: 603/E

Offered at: € 350,000

Estate ID: 34522

Ref: ba5229655

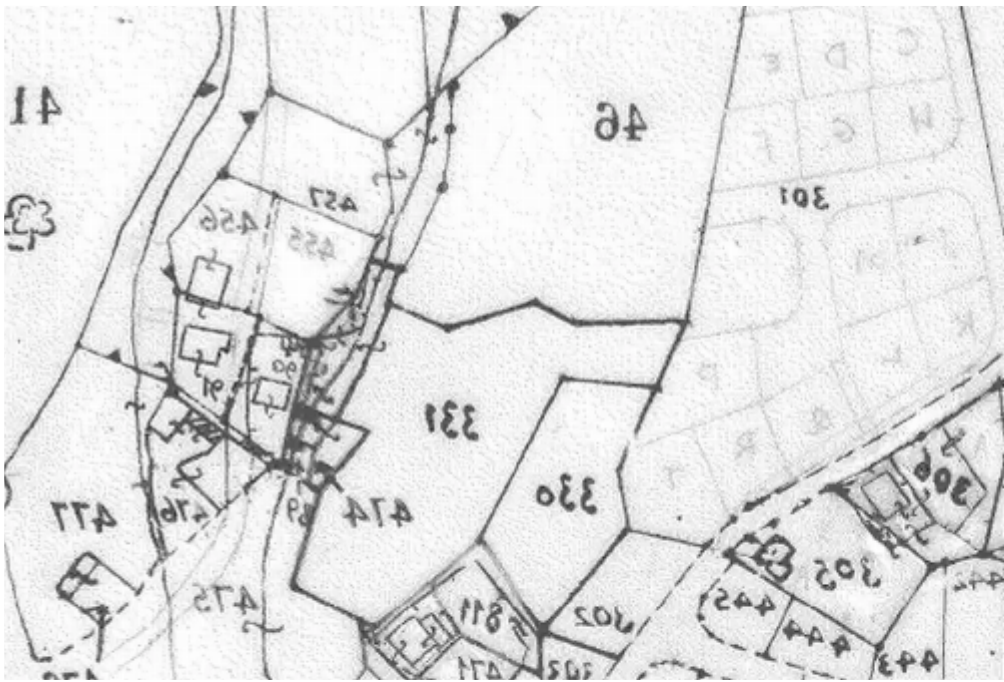



Total plot's-land's area: **5016 m²**



Available from: **2024-04-26**



Offered at: **350,000**



Type: **Residential**

""Residential Land for Sale in the picturesque village of Pirga in Larnaca. A short distance from Larnaca International Airport and Larnaca Town. The property is located at a distance of 360 m northwest of the center of Pirga and 1.8 km east of the Nicosia – Limassol motorway. It has easy access to the neighboring villages and the motorway to Larnaca, Limassol and Nicosia. The field extends to 5016 sq.m. in total. It has a relatively rectangular shape and a flat surface with a slight uphill slope from south to north. Also, it abuts on a public registered road along its southern boundary with a frontage of approximately 69 meters. The property is covered by the necessary services (ele...

Estate on map:





Website: realty.com.cy/p/residential-land-5016-m²-€350.000-ba5229655

Email: info@rimatech.com.cy

Phone: [+35795958898](tel:+35795958898) // [+35725714014](tel:+35725714014)

This ad is presented by listings admin, under supervision from ,
Licensed Real Estate Agent Reg no: 1234, Lic no: 603/E

