

Residential land 5356 m²

€280.000

Paphos, Tsada-8540 , Cyprus

This ad is presented by listings admin, under supervision from ,
Licensed Real Estate Agent Reg no: 1234, Lic no: 603/E

Offered at: € 280,000

Estate ID: 52302

Ref: ba5351172

**VILLAGE
TSADHA**

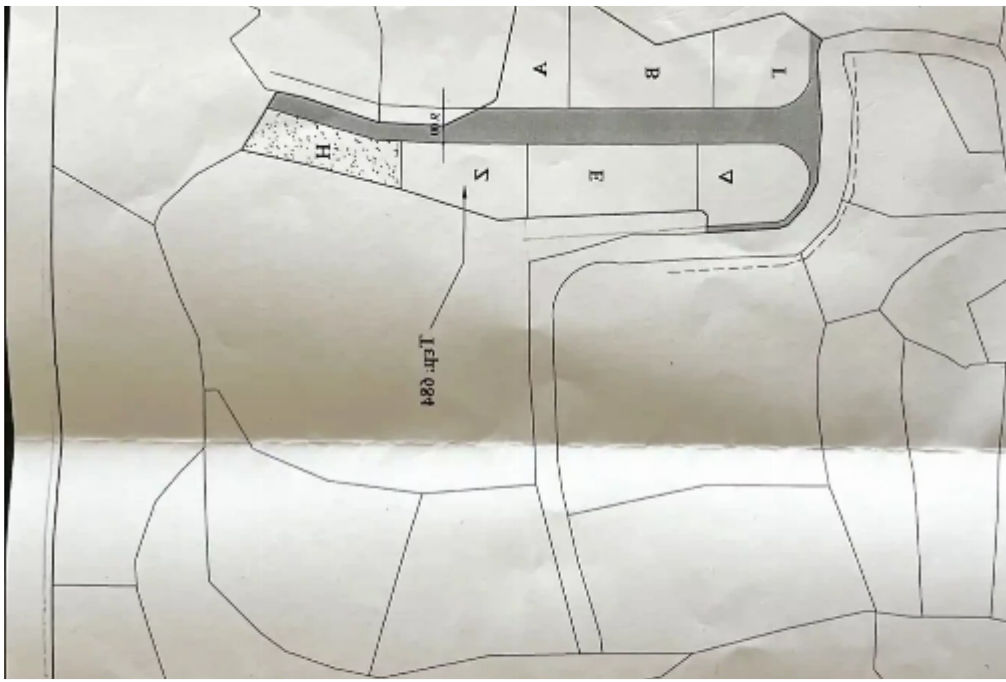



Total plot's-land's area: **5356 m²**



Coverage: **35 %**



Density: **60 %**



Available from: **2024-07-23**



Offered at: **280,000**



Type: **Residential**

image not found or type unknown



Planning zone: **H3**

Characteristics of the Field: - Located in zone H3 with 60% Building Density and 35% Coverage - Maximum number of floors: 2 Utilities and Features: - There is a water borehole with a permit - Located 10 minutes from Minthis Hills!! - There is electricity and water Additional Information: - It adjoins a registered road - It has a view of the wider area The price is €280,000 (NO VAT WILL BE INCLUDED IN THE PRICE - VAT FREE) For more info please contact - Paraskevi Konstantinou...

Estate on map:

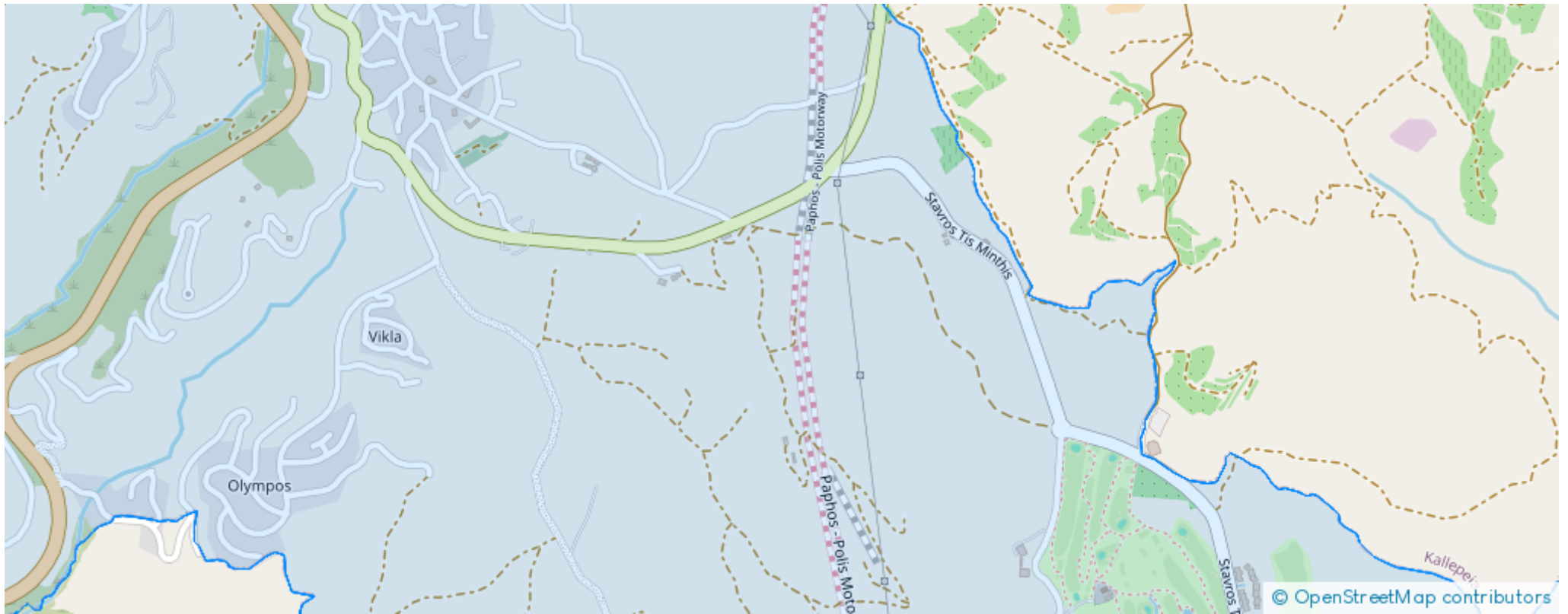



Website: realty.com.cy/p/residential-land-5356-m²-€280.000-ba5351172

Email: info@rimatech.com.cy

Phone: [+35795958898](tel:+35795958898) // [+35725714014](tel:+35725714014)

This ad is presented by listings admin, under supervision from ,
Licensed Real Estate Agent Reg no: 1234, Lic no: 603/E

