

000 : κρητὲΜ .ρηττ ΕΓ : κρητὲΜ Δ :

οιδὲχο ὀκνητρητκ ομητὶπε στο μτηνονιμφ ρωπο :

# ΜΥΣΙΑΚΗ ΤΗΤΚΟΙΔΙ ΑΙΧΙΟΤΣ

μηνυθὺζηΔ μακ αμονΟ'

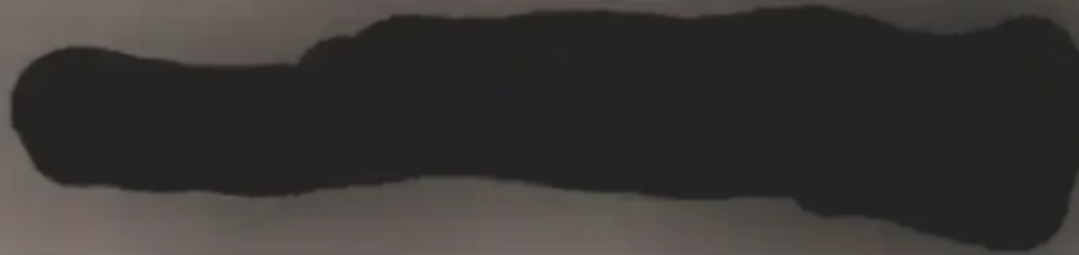

ΑΙΧΙΟΤΣ : ρηττ ΔΙΟΣ\ΙΟ\ΕΣ : ρηττ

ΤΗΤΚΟΙΔΙ ΑΙΧΙΟΤΣ

01\01\50 00,000.ΙΕΞ : 8105\10\10 ρωπο

ΑΙΧΙΟΤΣ

κρητὲΜ ρωπο , ρωπο κρητὲΜ 08, ΔΙ-θθ, Ε ρωπο κρητὲΜ κρητὲΜ  
κρητὲΜ 10 στο κρητὲΜ 01 ρωπο κρητὲΜ 8105\10\10

## Agricultural land 13600 m<sup>2</sup>

**€150.000**

Paphos, Polemi-8549 , Cyprus

This ad is presented by listings admin, under supervision from ,  
Licensed Real Estate Agent Reg no: 1234, Lic no: 603/E

**Offered at:** € 150,000

**Estate ID:** 59612

**Ref:** ba5394271

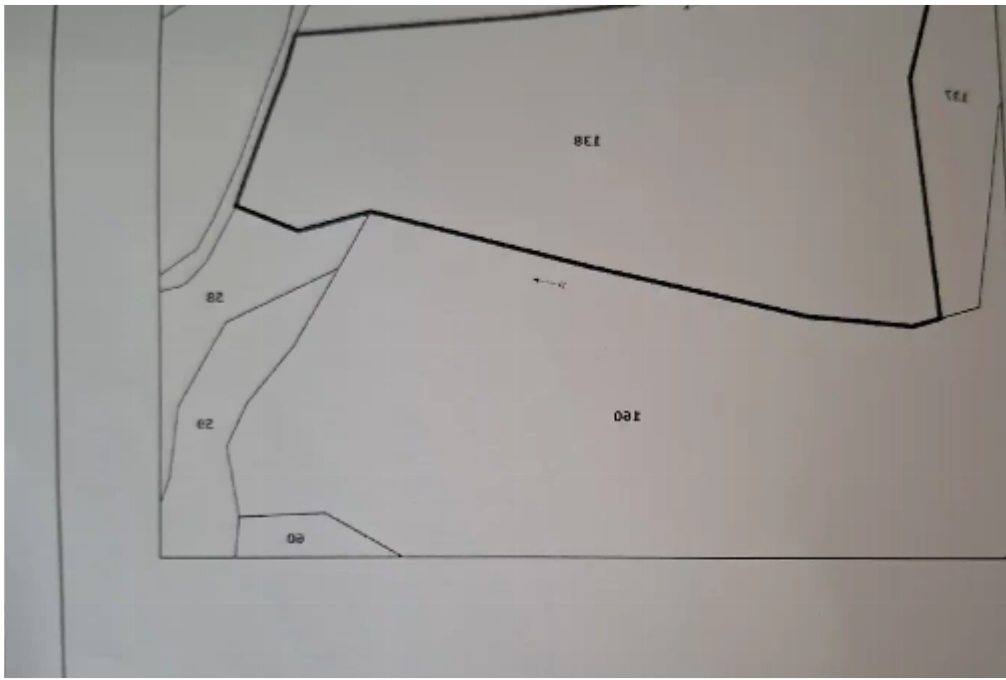



Total plot's-land's area: **13600 m<sup>2</sup>**



Available from: **2024-08-30**



Offered at: **150,000**



Type: **Agricultural**



Planning zone: **?3**

????????? ???????...

## Estate on map:

image not found or type unknown





**Website:** [realty.com.cy/p/agricultural-land-13600-m<sup>2</sup>-€150.000-ba5394271](https://realty.com.cy/p/agricultural-land-13600-m2-150000-ba5394271)

**Email:** [info@rimatech.com.cy](mailto:info@rimatech.com.cy)

**Phone:** [+35795958898](tel:+35795958898) // [+35725714014](tel:+35725714014)

This ad is presented by listings admin, under supervision from ,  
Licensed Real Estate Agent Reg no: 1234, Lic no: 603/E

