

ΚΥΡΙΑΚΑ: 1:200
Τηλέφωνο: 662
0:

οι δέχονται επίσημα στην Κτηματογράφηση :

ΣΤΟΙΧΕΙΑ ΙΔΙΟΚΤΗΤΗ ΚΑΙ ΣΥΜΦΕΡΟΝ

Μερίδιο	Όνομα και Διεύθυνση
ΟΛΟ	ΔΗΜΟΣ ΠΕΓΕΙΑΣ [Redacted Box] ΠΑΦΟΣ

Εγγράφοι: 54\01\2023
Αριθμοί φακέλων: 6\Δ\6\2023

ΚΙΝΗΤΟΙ ΙΔΙΟΚΤΗΤΕΣ

Καταβληθείσα: 01\01\2018 : €22.800,00
01\01\2021 : €198.200

ΔΟΥΛΕΙΕΣ \

Residential land 2007 m²

€350.000

Paphos, Pegeia-Coral-Bay-Kolpos-Korallion-8575 , Cyprus
This ad is presented by listings admin, under supervision from ,
Licensed Real Estate Agent Reg no: 1234, Lic no: 603/E

Offered at: € 350,000

Estate ID: 59714

Ref: ba5391017

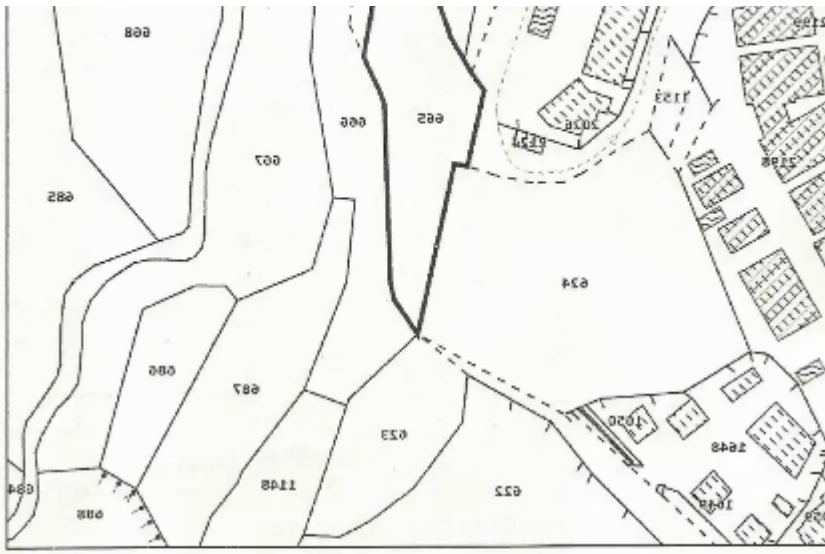



Total plot's-land's area: **2007 m²**



Coverage: **35 %**



Density: **60 %**



Available from: **2024-08-30**



Offered at: **350,000**



Type: **Residential**

image not found or type unknown



Planning zone: **H3**

????????? ?????????? ?????????? ?? ?????? ??? ?????? ?? ?????????? ??? ?? ?????? ??????????. ?????????? ?? ?????????????? ?????????????????? ?????? ??
????????? ?????????? 27 m. ? ?????????? ?????? ?? ??????????. ?????????? ??? ?????????? ??? ??????????....

Estate on map:

image not found or type unknown





Website: [realty.com.cy/p/residential-land-2007-m²-€350.000-ba5391017](https://realty.com.cy/p/residential-land-2007-m2-€350.000-ba5391017)

Email: info@rimatech.com.cy

Phone: [+35795958898](tel:+35795958898) // [+35725714014](tel:+35725714014)

This ad is presented by listings admin, under supervision from ,
Licensed Real Estate Agent Reg no: 1234, Lic no: 603/E

