



## Residential land 637 m<sup>2</sup>

**€125.000**

Nicosia, Psimolofou-2630 , Cyprus

This ad is presented by listings admin, under supervision from ,  
Licensed Real Estate Agent Reg no: 1234, Lic no: 603/E

**Offered at:** € 125,000

**Estate ID:** 64967

**Ref:** ba5455835

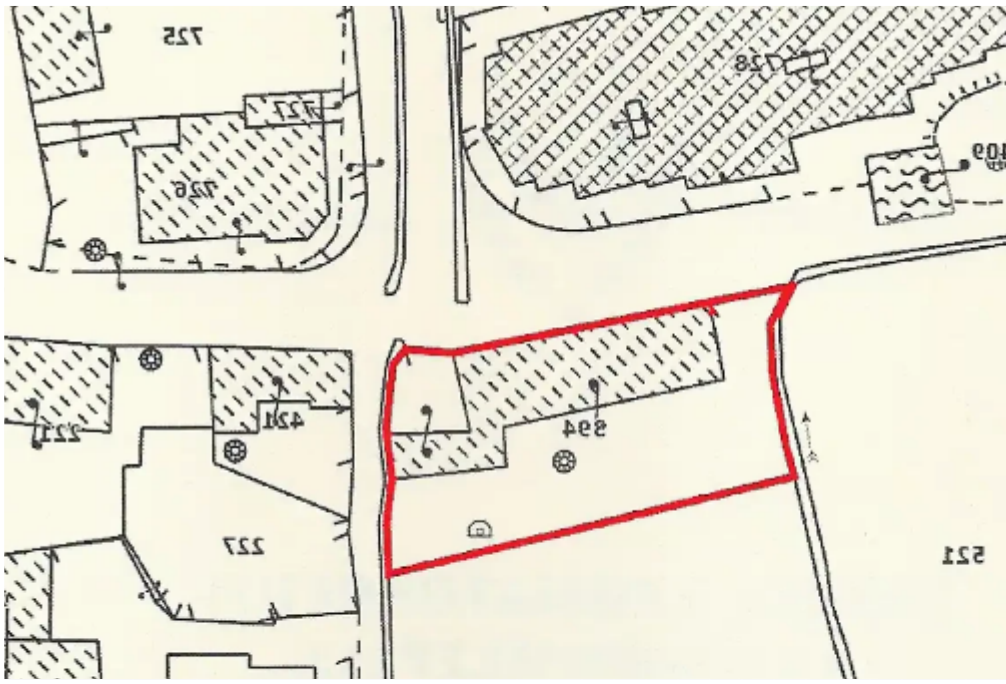



Total plot's-land's area: **637 m<sup>2</sup>**



Density: **90 %**



Available from: **2024-10-01**



Offered at: **125,000**



Type: **Residential**

""This family residential corner 637m2 Plot is ideal as its in the heart of Pano Deftera and very close to St. George's Church. Ideal for development as 90% density is permitted and to a 3 floor high level. Example is apartments building that's been built opposite. Recommend a visit to view."" ...

## Estate on map:

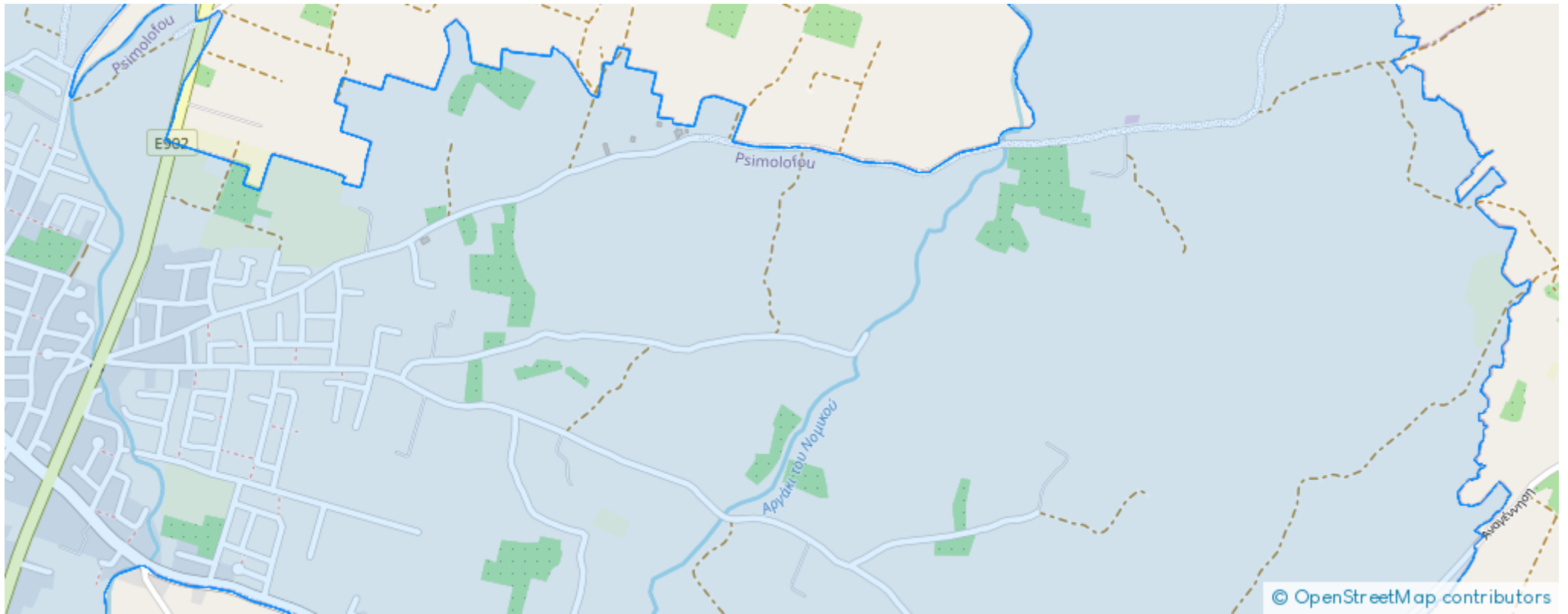



**Website:** [realty.com.cy/p/residential-land-637-m<sup>2</sup>-€125.000-ba5455835](https://realty.com.cy/p/residential-land-637-m2-€125.000-ba5455835)

**Email:** [info@rimatech.com.cy](mailto:info@rimatech.com.cy)

**Phone:** [+35795958898](tel:+35795958898) // [+35725714014](tel:+35725714014)

This ad is presented by listings admin, under supervision from ,  
Licensed Real Estate Agent Reg no: 1234, Lic no: 603/E

