



## 2-bedroom apartment f?r s?le

Limassol, Pano-Polemidia-4130 , Cyprus

This ad is presented by listings admin, under supervision from ,  
Licensed Real Estate Agent Reg no: 1234, Lic no: 603/E

**Offered at:** €310,000

**Estate ID:** 70055

**Ref:** ba5018249

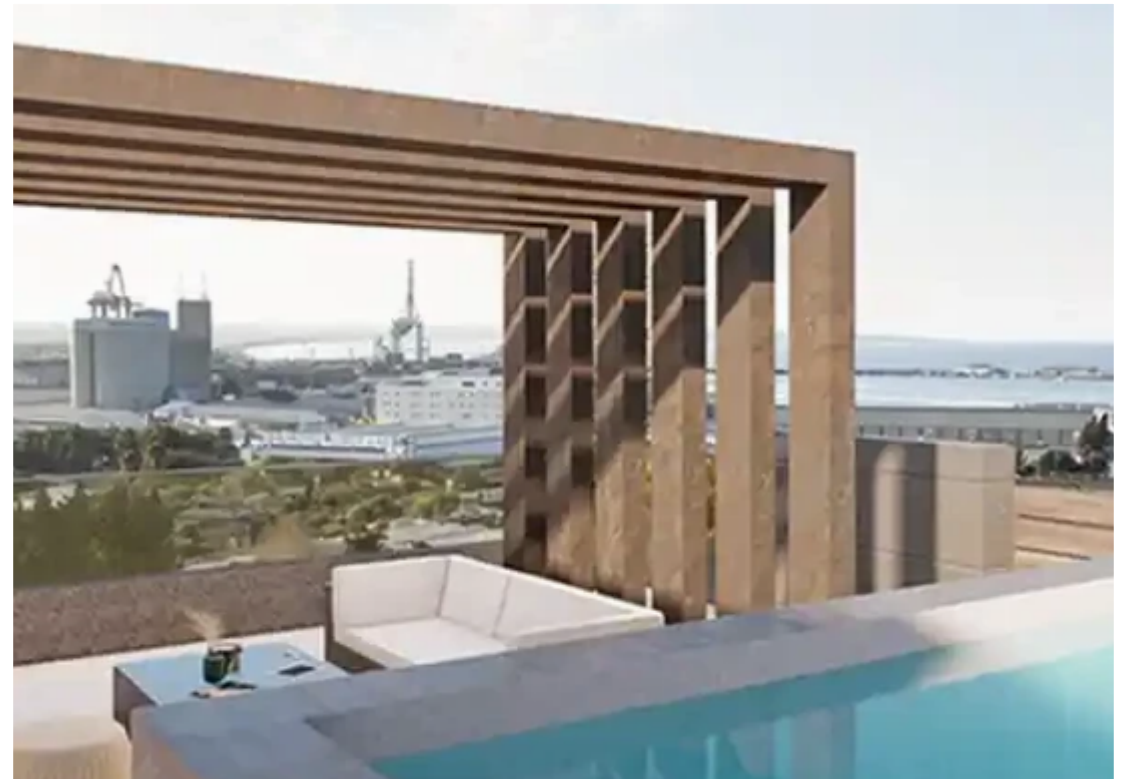



NET internal area: **99**



Bathrooms: **2**



Bedrooms: **2**



Parking spaces: **Covered cars**



Available from: **2024-10-25**



Offered at: **310,000**



Type: **Apartment**

.....In the serene and safe residential neighbourhood of Ekali, there stands a three-storey building offering six spacious two-bedroom apartments. Its a minutes drive from the motorway and within reach of all the amenities you need. The apartments are beautifully designed with a balance of modern comfort, functionality, and style. Each apartment spans an internal area of 78.8 square meters, supplemented by a 21.6 square meter covered veranda. Every unit also comes with its own storage room and a covered parking space. The design of these apartments leans towards modernity, with sleek interiors complemented by cosy elements for warmth. The large balconies featuring frameless glass ...

## Estate on map:

image not found or type unknown







**Website:** [realty.com.cy/p/2-bedroom-apartment-f?r-s?le-ba5018249](https://realty.com.cy/p/2-bedroom-apartment-f?r-s?le-ba5018249)

**Email:** [info@rimatech.com.cy](mailto:info@rimatech.com.cy)

**Phone:** [+35795958898](tel:+35795958898) // [+35725714014](tel:+35725714014)

This ad is presented by listings admin, under supervision from ,  
Licensed Real Estate Agent Reg no: 1234, Lic no: 603/E

